

SURVEY NOTES:
 1. THE SURVEY INFORMATION SHOWN ON THIS PLAN IS FROM A FIELD SURVEY COMPLETED IN JUNE 2016 BY MICHAEL UNDERWOOD AND ASSOCIATES, PA.
 2. NO SIGNIFICANT TREES EXIST ON SITE.

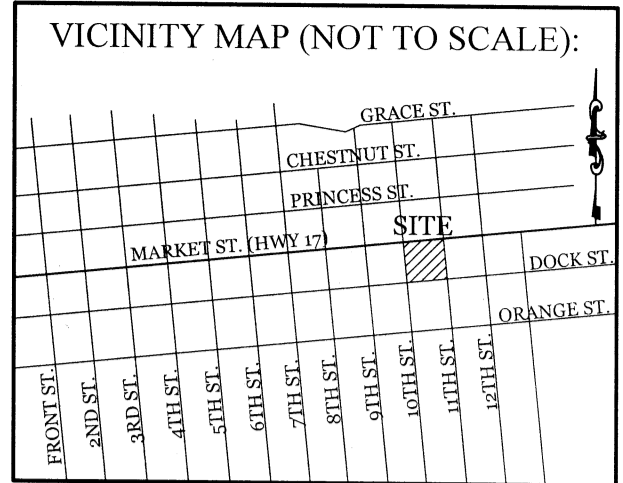

REVISIONS

INTRACOASTAL ENGINEERING, PLLC
 5725 Oleander Dr. Unit E-7
 Wilmington, North Carolina 28403
 Phone: (910) 859-8983
 Email: charlie@intracoastalengineering.com
 License Number P-0662

EXISTING CONDITIONS AND DEMOLITION PLAN
 FOR
FAMILY FARE MARKET ST.
 WILMINGTON, NC

CHARLES D. CAZIER
 10-21-16

CLIENT INFORMATION:
M. M. FOWLER, INC.
 LEE BARNES
 4220 NEAL ROAD
 DURHAM, NC 27705
 919-309-2925 EXT. 215

DRAWN:	BPD	SHEET SIZE:	24 x 36
CHECKED:	CDC	DATE:	10/21/2016
APPROVED:	CDC	SCALE:	1" = 20'
PROJECT NUMBER:	2015-049		

DRAWING NUMBER:
C-1

Approved Construction Plan

Name	Date
Planning	
Public Utilities	
Traffic	
Fire	

STORMWATER MANAGEMENT PLAN
APPROVED
 CITY OF WILMINGTON
 ENGINEERING DEPARTMENT
 DATE PERMIT #
 SIGNED

LEGEND

- PROPERTY LINE
- CONTOUR
- CENTER LINE
- TEMPORARY SILT FENCE
- LIMITS OF DISTURBANCE
- CONCRETE/ASPHALT TO BE REMOVED

Scale: 1" = 20'

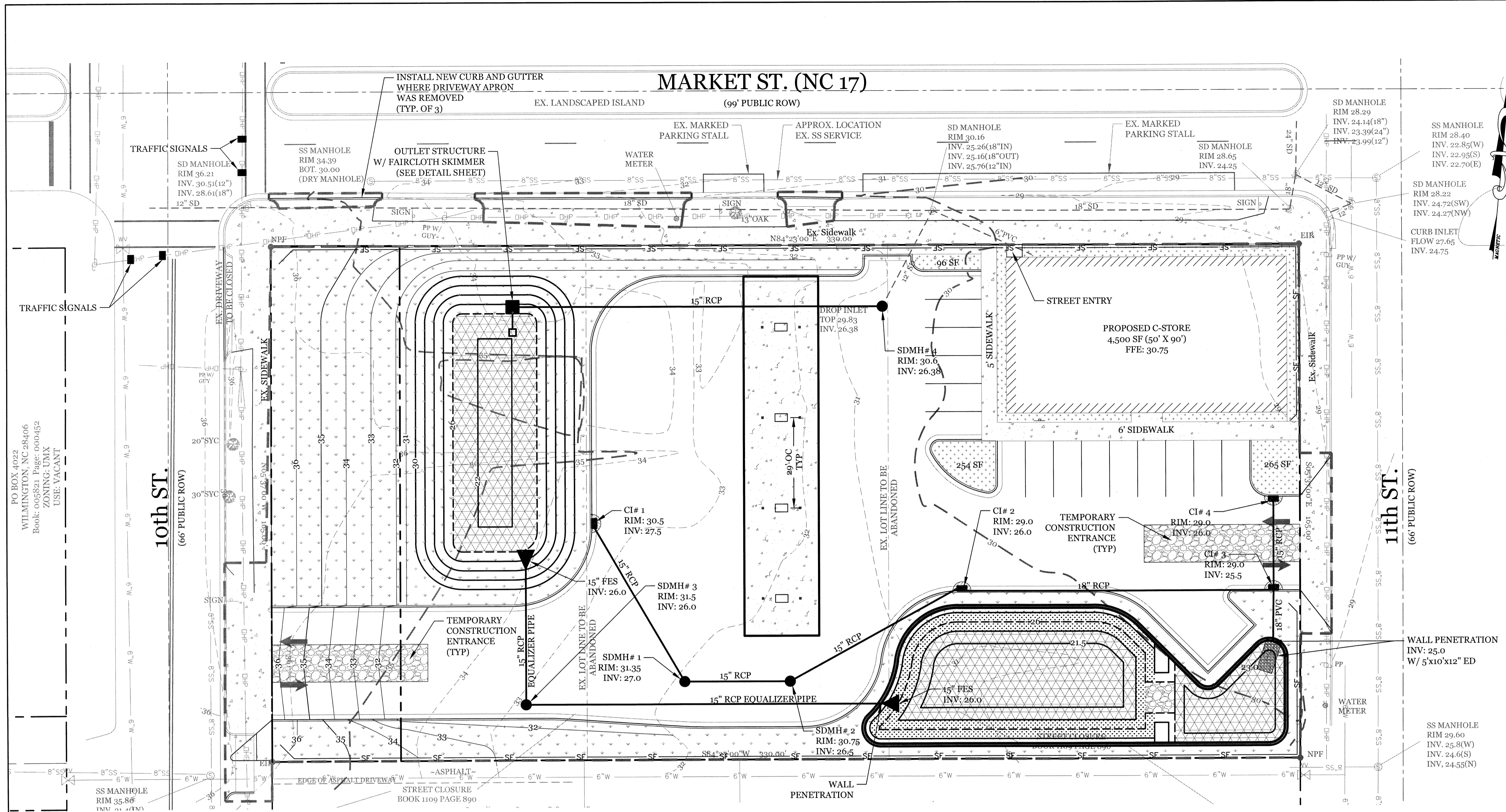

NORTH CAROLINA TEMPORARY GRASSING DETAIL

SEEDING MIXTURE SPECIES	APPLICATION RATE
LATE WINTER & EARLY SPRING: Rye (grain) Annual Lespedeza (Kobe in Piedmont and Coastal Plain, Korean in Mountains) Omit annual Lespedeza when duration of temporary cover is not to extend beyond June	100 (lb/acre)
SUMMER: German Millet In the Piedmont and Mountains, a small-stemmed sundangrass may be substituted at a rate of 50 (lb/acre)	50 (lb/acre)
FALL: Rye (grain)	120 (lb/acre)

SEEDING DATES

LATE WINTER & EARLY SPRING: Mountains - Above 2500 ft: Feb. 15-May 15 Piedmont - Jan. 1-May 1 Coastal Plain - Dec. 1-Apr. 15
SUMMER: Mountains - May 15-Aug. 15 Piedmont - May 1-Aug. 15 Coastal Plain - Apr. 15-Aug. 15
FALL: Mountains - Aug. 15-Dec. 15 Coastal Plain and Piedmont - Aug. 15-Dec. 30

SOIL AMENDMENTS:

Follow recommendations of soil tests or apply 2,000 lb/acre ground agricultural limestone and 750 lb/acre 10-10-10 fertilizer.

MULCH:

apply 4,000 lb/acre straw, anchor straw by tacking with asphalt, netting, or a mulch anchoring tool. A disk with blades set nearly straight can be used as a mulch anchoring tool.

MAINTENANCE:

Refertilize if growth is not fully adequate, reseed, refertilize and mulch immediately following erosion or other damage.

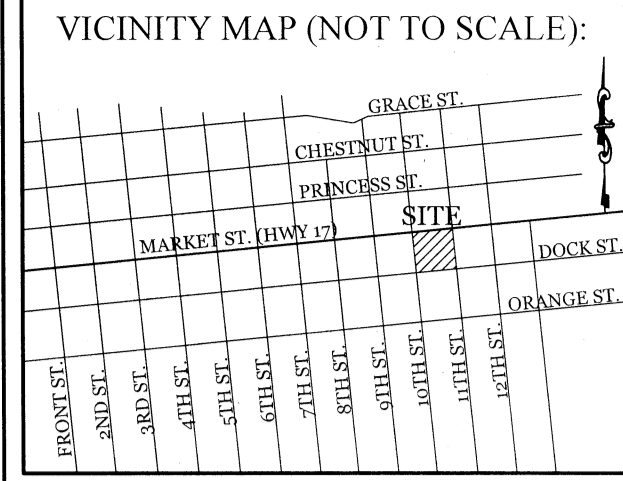

REVISIONS

NO.	DATE	DESCRIPTION

INTRACOASTAL ENGINEERING, PLLC

5725 Oleander Dr. Unit E-7
Wilmington, North Carolina 28403
Phone: (910) 859-8983
Email: Charlie@intracoastalengineering.com
License Number: P-0662

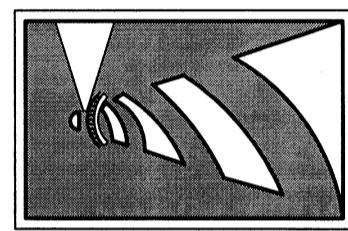

NORTH CAROLINA PERMANENT GRASSING DETAIL

SEEDING MIXTURE SPECIES	APPLICATION RATE
FALL & WINTER: Tall Fescue (blend of two or three improved varieties) Rye (grain)	200 (lb/acre) 25 (lb/acre)
SPRING & SUMMER: Pensacola Bahiagrass Sericea Lespedeza Common Bermudagrass German Millet Tall Fescue	50 (lb/acre) 30 (lb/acre) 10 (lb/acre) 10 (lb/acre) 50 (lb/acre)

SEEDING DATES

FALL & WINTER:
January - April
August - December

SOIL AMENDMENTS:
Apply lime and fertilizer according to soil tests, or apply 3,000-5,000 lb/acre ground agricultural limestone (use the lower rate on sandy soils) and 1,000 lb/acre 10-10-10 fertilizer.

MAINTENANCE:
Fertilize according to soil tests or apply 40 lb/acre nitrogen in January or February, 40 lb in September and 40 lb in November, from a 12-4-8, 16-4-8, or similar turf fertilizer. Avoid fertilizer applications during warm weather, as this increases stand losses to disease. Reseed, fertilize, and mulch damaged areas immediately. mow to a height of 2.5-3.5 inches as needed.

SPRING & SUMMER:
April 1 - July 15

SOIL AMENDMENTS:
Apply lime and fertilizer according to soil tests, or apply 3,000 lb/acre ground agriculture limestone and 500 lb/acre 10-10-10 fertilizer.

MAINTENANCE:
Refertilize the following april with 50 lb/acre nitrogen. Repeat as growth requires. may be mowed only once a year. Where a neat appearance is desired, omit sericea and mow as often as needed.

MULCH:
apply 4,000 lb/acre straw, anchor straw by tacking with asphalt, netting, or a mulch anchoring tool. A disk with blades set nearly straight can be used as a mulch anchoring tool.

SEDIMENTATION & EROSION CONTROL PLAN

FOR
FAMILY FARE MARKET ST.
WILMINGTON, NC

SYMBOL	GROUND STABILIZATION CRITERIA	
	SITE AREA DESCRIPTION	STABILIZATION TIMEFRAME
	Perimeter dikes, swales, ditches and slopes	7 Days
	High Quality Water (HQW) Zones	7 Days
	Slopes Steeper than 3:1	7 Days
	Slopes 3:1 or flatter	14 Days
	All other areas with slopes flatter than 4:1	14 Days

- SURVEY NOTES:**
- THE SURVEY INFORMATION SHOWN ON THIS PLAN IS FROM A FIELD SURVEY COMPLETED IN JUNE 2016 BY MICHAEL UNDERWOOD AND ASSOCIATES, PA.
 - NO SIGNIFICANT TREES EXIST ON SITE.
- DEVELOPMENT NOTES:**
- ALL DEVELOPMENT SHALL BE IN ACCORDANCE WITH CITY OF WILMINGTON ZONING ORDINANCE.
 - PROJECT SHALL COMPLY WITH ALL FEDERAL, STATE & NEW HANOVER COUNTY REGULATIONS.
 - PROPERTY IS LOCATED IN ZONE "X" ACCORDING TO THE FEMA FLOOD INSURANCE RATE MAP, 37203127001 COMMUNITY-PANEL NUMBER 3127, DATED 04/03/06

- CONSTRUCTION SEQUENCE:**
- CONSTRUCTION OF SITE TO START WITH INSTALLATION OF CONSTRUCTION ENTRANCE AND SILT FENCE ALONG ALL LOCATIONS PER PLANS. UPON INSTALLATION OF SILT FENCE, DEMOLITION OF EXISTING IMPERVIOUS PAVEMENT AND DRAINAGE STRUCTURES IDENTIFIED TO BE REMOVED MAY BEGIN. ALL SLOPED AREAS SHOULD BE SEEDED IN ACCORDANCE TO SPECIFICATIONS. SLOPE STABILIZATION IS WITHIN 21 CALENDAR DAYS OF ANY PHASE OF CONSTRUCTION. ALL OTHER AREAS MUST BE STABILIZED WITHIN 15 WORKING DAYS. CONTRACTOR TO FOLLOW NPDES STABILIZATION REQUIREMENTS PER TABLE ON THIS SHEET AS WELL. MOST STRINGENT REQUIREMENT TO BE MET.
- GENERAL CLEARING AND GRADING OF THIS SITE WILL NOT BE DONE UNTIL THE TEMPORARY SILT FENCE & CONSTRUCTION ENTRANCE HAS BEEN INSTALLED.
 - NO CUT SLOPE OR FILL SLOPE SHALL EXCEED A RISE OR FALL OF ONE FOOT FOR EVERY RUN OF 3 FEET (1 VERTICAL TO 3 HORIZONTAL).
 - NO SEDIMENT WILL BE ALLOWED TO EXIT THE SITE. ALL EROSION SHALL BE CONTROLLED INCLUDING SIDE SLOPES DURING AND AFTER CONSTRUCTION.
 - INSTALL PRIMARY EROSION CONTROL MEASURES BEFORE BEGINNING CONSTRUCTION INCLUDING BUT NOT LIMITED TO GRAVELED CONSTRUCTION ENTRANCE, SILT FENCE, TREE PROTECTION FENCE & SEDIMENT BASINS. CONTRACTOR TO BE FAMILIAR WITH USACE GENERAL PERMIT CONDITIONS FOR ROAD CROSSINGS. SPECIFIC CONSTRUCTION METHODS MAY BE REQUIRED ABOVE AND BEYOND WHAT IS SPECIFIED IN THIS PLAN. INSTALL ALL SECONDARY EROSION CONTROL MEASURES, SUCH AS INLET PROTECTION AS SOON AS POSSIBLE AFTER BEGINNING CONSTRUCTION.
 - ALL EROSION CONTROL MEASURES TO BE INSPECTED AFTER EACH RAIN. SILT FENCE AND INLET PROTECTION TO BE CLEANED WHEN HALF FULL.
 - A 4" LAYER OF TOPSOIL SHALL BE APPLIED TO ALL NEW AREAS TO BE GRASSED.
 - MAINTAIN ALL EROSION CONTROL MEASURES UNTIL PROJECT IS COMPLETE.
 - MORE STRINGENT MEASURES MAY BE REQUIRED TO HALT EROSION IF THOSE ON THIS PLAN PROVE TO BE LESS EFFECTIVE.
 - REMOVE ALL TEMPORARY EROSION CONTROL MEASURES UPON COMPLETION OF CONSTRUCTION. ALL PERMANENT MEASURES SHALL BE WELL ESTABLISHED PRIOR TO PROJECT COMPLETION.

- MAINTENANCE PLAN:**
- ALL EROSION AND SEDIMENT CONTROL PRACTICES WILL BE CHECKED FOR STABILITY AND OPERATION FOLLOWING EVERY RUNOFF-PRODUCING RAINFALL, BUT IN NO CASE, LESS THAN ONCE EVERY WEEK AND WITHIN 24 HOURS OF EVERY HALF INCH RAINFALL.
 - ALL POINTS OF EGRESS WILL HAVE CONSTRUCTION ENTRANCES THAT WILL BE PERIODICALLY TOP-DRESSED WITH AN ADDITIONAL 2 INCHES OF 2-3 INCH STONE TO MAINTAIN PROPER DEPTH. THEY WILL BE MAINTAINED IN A CONDITION TO PREVENT MUD OR SEDIMENT FROM LEAVING THE SITE. IMMEDIATELY REMOVE OBJECTIONABLE MATERIAL, SPILLED, WASHED OR TRACKED ONTO THE CONSTRUCTION ENTRANCE OR ROADWAYS.
 - SEDIMENT WILL BE REMOVED FROM HARDWARE CLOTH AND GRAVEL INLET PROTECTION, ROCK DOUGHNUT INLET PROTECTION, SEDIMENT TRAP BAFFLES, AND ROCK PIPE INLET PROTECTION WHEN THE DESIGNED STORAGE CAPACITY HAS BEEN HALF FILLED WITH SEDIMENT. ROCK WILL BE CLEANED OR REPLACED WHEN THE SEDIMENT POOL NO LONGER DRAINS AS DESIGNED. DEBRIS WILL BE REMOVED FROM THE ROCK AND HARDWARE CLOTH TO ALLOW PROPER DRAINAGE. SILT SACKS WILL BE EMPTIED ONCE A WEEK AND AFTER EVERY RAIN EVENT. SEDIMENT WILL BE REMOVED FROM AROUND BEAVER DAMS, DANDY SACKS AND SOCKS ONCE A WEEK AND AFTER EVERY RAIN EVENT.
 - CHECK SEDIMENT BASIN AND BAFFLES WEEKLY & AFTER EACH RAINFALL EVENT. REMOVE SEDIMENT FROM TRAP & BAFFLES AND RESTORE TO ORIGINAL VOLUME WHEN SEDIMENT ACCUMULATES TO ABOUT 1/2 THE DESIGN VOLUME. REPAIR / REPLACE BAFFLES IF TORN, COLLAPSED, OR INEFFECTIVE.
 - DIVERSION DITCHES WILL BE CLEANED OUT IMMEDIATELY TO REMOVE SEDIMENT OR OBSTRUCTIONS FROM THE FLOW AREA. THE DIVERSION RIDGES WILL ALSO BE REPAIRED. SWALES MUST BE TEMPORARILY STABILIZED WITHIN 21 CALENDAR DAYS OF CEASE OF ANY PHASE OF ACTIVITY ASSOCIATED WITH A SWALE. SEDIMENT WILL BE REMOVED FROM BEHIND THE SEDIMENT FENCE WHEN IT BECOMES HALF FILLED. THE SEDIMENT FENCE WILL BE REPAIRED AS NECESSARY TO MAINTAIN A BARRIER. STAKES MUST BE STEEL. STAKE SPACING WILL BE 6 FEET MAX. WITH THE USE OF EXTRA STRENGTH FABRIC, WITHOUT WIRE BACKING. STAKE SPACING WILL BE 8 FEET MAX WHEN STANDARD STRENGTH FABRIC AND WIRE BACKING ARE USED. IF ROCK FILTERS ARE DESIGNED AT LOW POINTS IN THE IN THE SEDIMENT FENCE THE ROCK WILL BE REPAIRED OR REPLACED IF IT BECOMES HALF FULL OF SEDIMENT, NO LONGER DRAINS AS DESIGNED OR IS DAMAGED.

Approved Construction Plan

Name	Date
Planning	_____
Public Utilities	_____
Traffic	_____
Fire	_____

STORMWATER MANAGEMENT PLAN

APPROVED

CITY OF WILMINGTON
ENGINEERING DEPARTMENT

DATE _____ PERMIT # _____
SIGNED _____

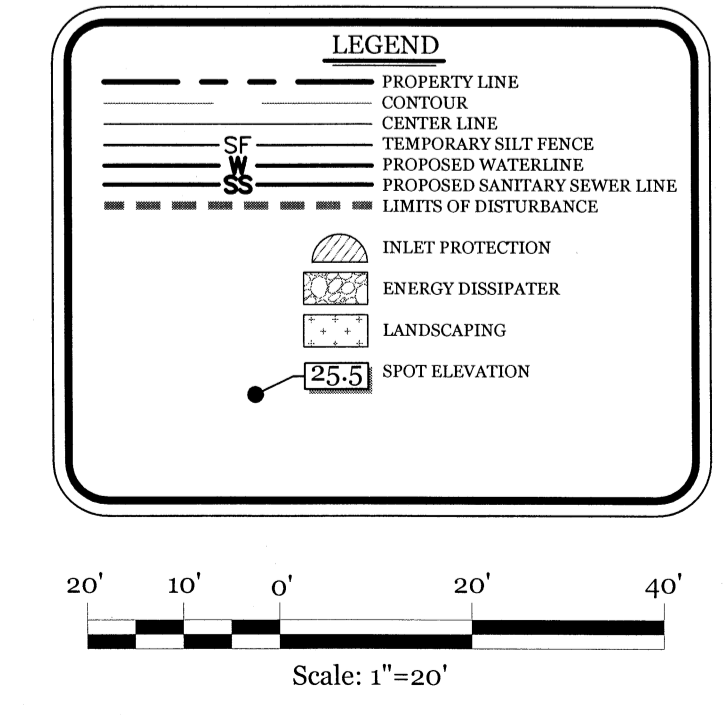

Charles D. Czizir
10-21-16

CLIENT INFORMATION:

M. M. FOWLER, INC.
LEE BARNES
4220 NEAL ROAD
DURHAM, NC 27705
919-309-2925 EXT. 215

DRAWN: BPD	SHEET SIZE: 24 x 36
CHECKED: CDC	DATE: 10/21/2016
APPROVED: CDC	SCALE: 1" = 20'
PROJECT NUMBER: 2015-049	

DRAWING NUMBER:
C-2 2 OF 8

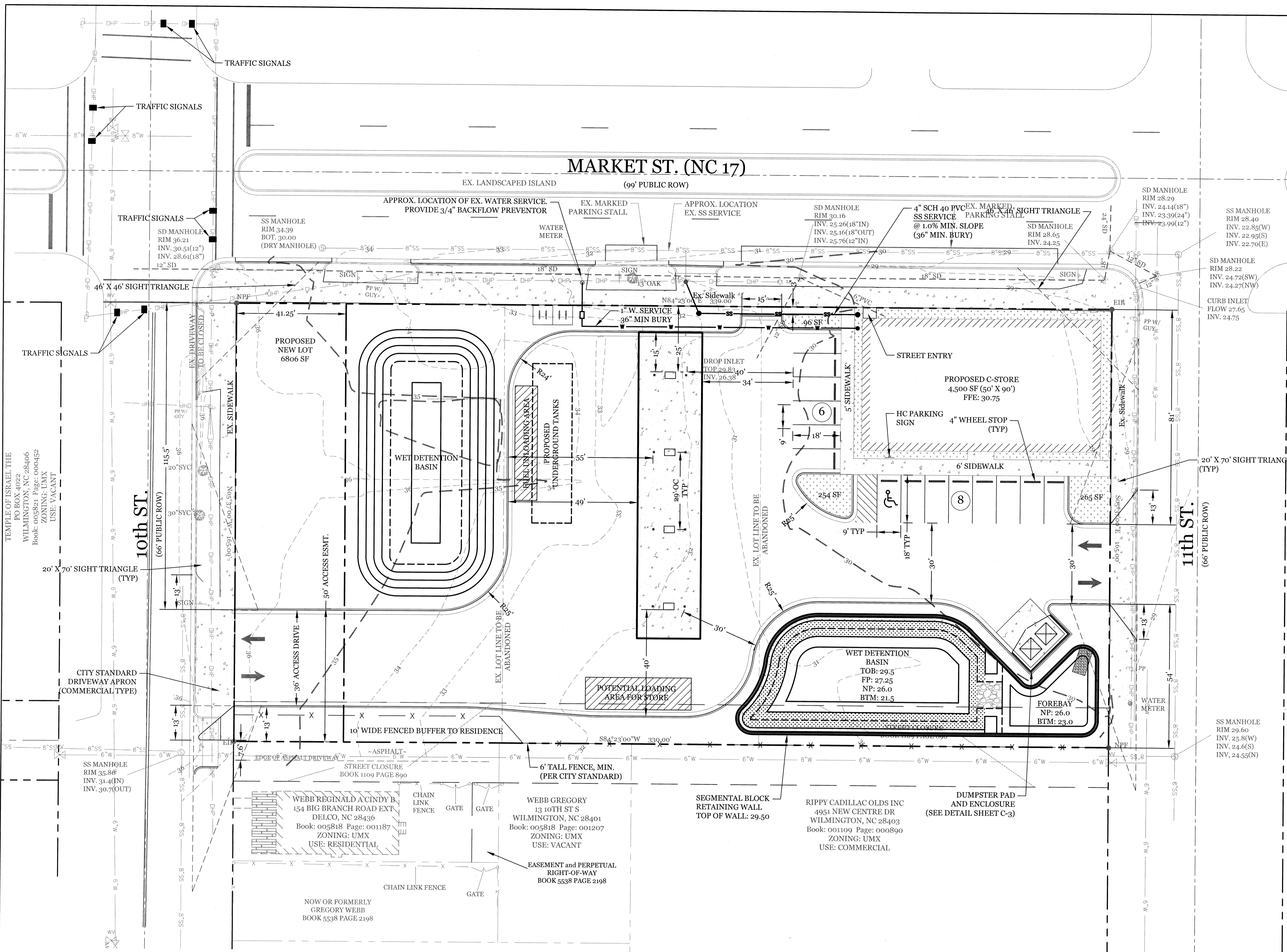

SITE DATA:
 PROPERTY CURRENTLY OWNED BY:
 R & R COMPANY WILMINGTON LLC
 4951 NEW CENTRE DR
 WILMINGTON, NC 28403
 &
 RIPPY CADILLAC OLDS INC
 4951 NEW CENTRE DR
 WILMINGTON, NC 28401

PROPERTY ADDRESS:
 6 S 11th ST
 WILMINGTON, NC

NEW HANOVER COUNTY PINS:
 Ro4818-030-004-000,
 Ro4818-030-003-000,
 Ro4818-030-001-000

TOTAL TRACT AREA: ±1.25 AC. (54,450 SF)
 DISTURBED AREA: ±1.25 AC. (54,450 SF)
 CURRENT ZONING: CITY OF WILMINGTON
 UMX (URBAN MIXED USE)
 CAMA CLASSIFICATION:
 URBAN

SETBACKS:
 FRONT REQ'D= 0' PROP= 4'
 REAR REQ'D= 0' PROP= 111'
 SIDE REQ'D= 0' PROP= 4' L/195'R

PROPOSED LAND USE:
 CONVENIENT STORE

GROSS FLOOR AREA:
 4,500 SF (8.3% LOT COVERAGE)

BUILDING HEIGHT: ±20'

EXISTING IMPERVIOUS SURFACES:
 PAVEMENT/BLDG PADS = 33,988 SF (62.4%)
 TO REMAIN= 0 SF

PROPOSED ONSITE IMPERVIOUS SURFACES:
 BUILDINGS= 4,500 SF
 PAVEMENT= 25,734 SF
 (ASPHALT/CONCRETE)
 SIDEWALKS= 947 SF
 FUTURE (OUTPARCEL)= 4,504 SF
 TOTAL IMPERVIOUS= 35,685 SF (65.5%)

OFFSITE IMPERVIOUS SURFACES:
 DRIVEWAY APRONS= 1,500 SF

TOTAL PARKING PROVIDED: 14 SPACES (1 HC)

BICYCLE PARKING REQUIRED:
 (5 spaces or 1 per 1,000 sq GFA)
 PROVIDED:
 REQUIRED: 5 SPACES
 PROVIDED: 8 SPACES

STREETYARD:
 REQUIRED: 0 SF
 PROVIDED: 0 SF

FOUNDATION PLANTINGS:
 REQUIRED: 336 SF (2,800 SF X 12%)
 PROVIDED: 411 SF

WATER AND SEWER DEMAND:
 (250 GPD PER PLUMBING FIXTURE)
 SEWER: @ 250 GPD X 4= 1,000 GPD
 WATER: @ 250 GPD X 4= 1,000 GPD

W K HOBBS INVESTMENTS LLC
 6327 MARYWOOD DR
 WILMINGTON, NC 28409
 Book: 005848 Page: 002725
 USE: COMMERCIAL

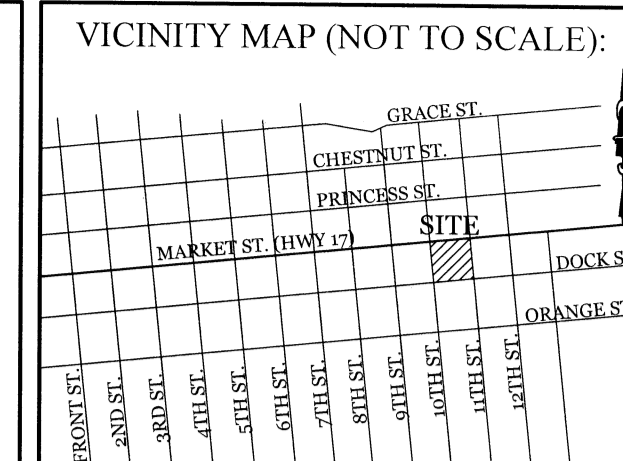

REVISIONS

INTRACOASTAL ENGINEERING, PLLC
 5725 Oleander Dr. Unit E-7
 Wilmington, North Carolina 28403
 Phone: (910) 859-8983
 Email: charlie@intracoastalengineering.com
 License Number P-0662

SITE AND UTILITIES PLAN

FOR

FAMILY FARE MARKET ST.
 WILMINGTON, NC

CLIENT INFORMATION:
 M. M. FOWLER, INC.
 LEE BARNES
 4220 NEAL ROAD
 DURHAM, NC 27705
 919-309-2925 EXT. 215

DRAWN:	BPD	SHEET SIZE:	24 x 36
CHECKED:	CDC	DATE:	10/21/2016
APPROVED:	CDC	SCALE:	1" = 20'
PROJECT NUMBER:	2015-049		

DRAWING NUMBER:
C-3
 3 OF 8

- SURVEY NOTES:**
- THE SURVEY INFORMATION SHOWN ON THIS PLAN IS FROM A FIELD SURVEY COMPLETED IN JUNE 2016 BY MICHAEL UNDERWOOD AND ASSOCIATES, PA.
 - NO SIGNIFICANT TREES EXIST ON SITE.
- DEVELOPMENT NOTES:**
- ALL DEVELOPMENT SHALL BE IN ACCORDANCE WITH CITY OF WILMINGTON ZONING ORDINANCE.
 - PROJECT SHALL COMPLY WITH ALL FEDERAL, STATE & NEW HANOVER COUNTY REGULATIONS.
 - PROPERTY IS LOCATED IN ZONE "X" ACCORDING TO THE FEMA FLOOD INSURANCE RATE MAP, 37203127001 COMMUNITY-PANEL NUMBER 3127, DATED 04/03/06
 - ALL SIGHT LIGHTING SHALL BE LOCATED, ANGLED, SHIELDED, AND/OR LIMITED IN INTENSITY SO AS TO CAST NO DIRECT LIGHT UPON ADJACENT PROPERTIES, SHALL MINIMIZE OFF-SITE BACKLIGHTING GLARE, AND UP-LIGHTING. LIGHT POSTS SHALL BE NO TALLER THAN TWELVE (12) FEET.

- UTILITY NOTES:**
- WATER AND SANITARY SEWER SERVICES ARE CURRENTLY AVAILABLE TO THE SITE FROM CAPE FEAR PUBLIC UTILITY AUTHORITY PUBLIC MAINS.
 - ALL PROPOSED UTILITY SERVICES, SUCH AS ELECTRIC POWER, CATV, GAS & TELEPHONE SHALL BE INSTALLED UNDERGROUND.
 - SOLID WASTE DISPOSAL BY PRIVATE DUMPSTER SERVICE.
 - ALL WATER & SEWER UTILITIES TO BE INSTALLED PER CFPWA TECHNICAL SPECIFICATIONS & STANDARDS.
 - PROJECT SHALL COMPLY WITH CFPWA CROSS CONNECTION CONTROL REQUIREMENTS. WATER METERS CANNOT BE RELEASED UNTIL ALL REQUIREMENTS ARE MET AND N.C.D.E.N.R. HAS ISSUED THEIR "FINAL APPROVAL". CALL 343-3910 FOR INFORMATION.
 - ANY BACKFLOW PREVENTION DEVICES REQUIRED BY THE CFPWA WILL NEED TO BE ON THE LIST OF APPROVED DEVICES BY USFCCCHCR OR ASSE.
 - IF CONTRACTOR DESIRES CFPWA WATER FOR CONSTRUCTION, HE SHALL APPLY IN ADVANCE FOR THIS SERVICE AND MUST PROVIDE A REDUCED PRESSURE ZONE (RPZ) BACKFLOW PREVENTION DEVICE ON THE DEVELOPER'S SIDE OF THE WATER METER BOX.
 - WHEN PVC WATER MAINS AND SERVICES ARE PROPOSED, THE PIPES ARE TO BE MARKED WITH NO. 10 INSULATED, SINGLE-STRAND COPPER WIRE INSTALLED & STRAPPED TO THE PIPES WITH DUCT TAPE. THIS IS TO BE ACCESSIBLE IN ALL VALVES AND METER BOXES TO AID IN FUTURE LOCATION OF FACILITIES.
 - THE CONTRACTOR IS RESPONSIBLE FOR THE LOCATION AND PROTECTION OR EXISTING UTILITIES DURING CONSTRUCTION. CALL U-1000 AT 1-800-622-4949. CONTRACTOR IS RESPONSIBLE FOR THE REPAIR AND REPLACEMENT OF ANY UTILITIES, CURB & GUTTER, PAVEMENT, ETC. THAT MAY BE DAMAGED DURING CONSTRUCTION. DAMAGED ITEMS SHALL BE REPAIRED TO AT LEAST THE QUALITY OR WORKMANSHIP FOUND IN THE ORIGINAL ITEM.

- GENERAL TRAFFIC NOTES:**
- ALL PAVEMENT MARKINGS IN PUBLIC RIGHTS-OF-WAY AND FOR DRIVEWAYS ARE TO BE THERMOPLASTIC AND MEET CITY AND/OR NCDOT STANDARDS. [DETAIL SD -13 COFW TECH STDS]
 - ALL SIGNS AND PAVEMENT MARKINGS IN AREAS OPEN TO PUBLIC TRAFFIC ARE TO MEET MUTCD (MANUAL ON UNIFORM TRAFFIC CONTROL DEVICES) STANDARDS. [DETAIL SD 15-13 COFW TECH STDS]
 - ALL TRAFFIC CONTROL SIGNS AND MARKINGS OFF THE RIGHT-OF-WAY ARE TO BE MAINTAINED BY THE PROPERTY OWNER IN ACCORDANCE WITH MUTCD STANDARDS.
 - ALL PARKING STALL MARKINGS AND LANE ARROWS WITHIN THE PARKING AREAS SHALL BE WHITE.
 - A UTILITY CUT PERMIT IS REQUIRED FOR EACH OPEN CUT OF A CITY STREET. NOTE THIS ON THE PLAN AND CONTACT 341-5888 FOR MORE DETAILS. IN CERTAIN CASES AN ENTIRE RESURFACING OF THE AREA BEING OPEN CUT MAY BE REQUIRED.
 - ANY BROKEN OR MISSING SIDEWALK PANELS, DRIVEWAY PANELS AND CURBING WILL BE REPLACED.
 - A LANDSCAPING PLAN INDICATING THE LOCATION OF REQUIRED STREET TREES SHALL BE SUBMITTED TO THE CITY OF WILMINGTON TRAFFIC ENGINEERING DIVISION AND PARKS AND RECREATION DEPARTMENT FOR REVIEW AND APPROVAL PRIOR TO THE RECORDING OF THE FINAL PLAT. [SD 15 -14 COFW TECH STDS]
 - CONTACT TRAFFIC ENGINEERING AT 341-7888 FORTY-EIGHT HOURS PRIOR TO ANY EXCAVATION IN THE RIGHT OF WAY.
 - ALL PROPOSED VEGETATION WITHIN SIGHT TRIANGLES SHALL NOT INTERFERE WITH CLEAR VISUAL SIGHT LINES FROM 30' TO 10'.

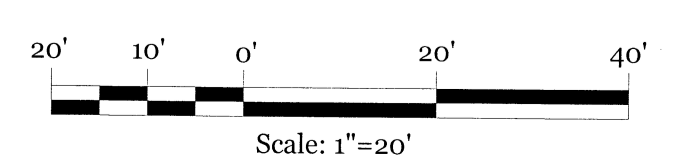
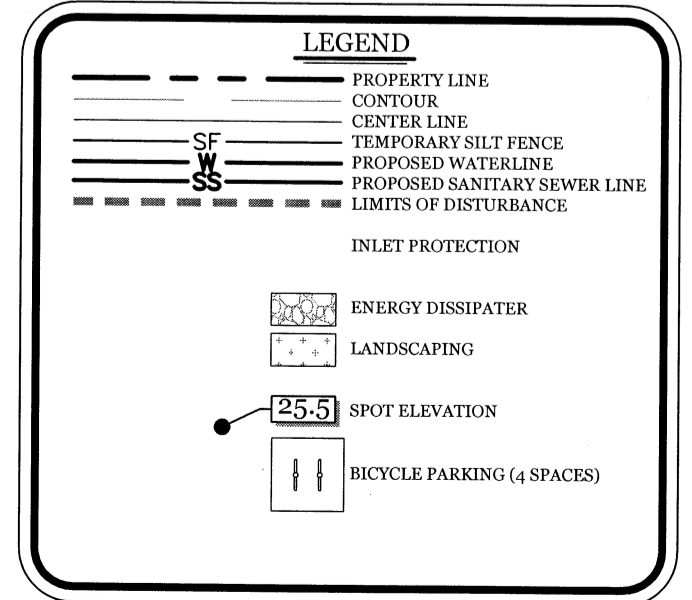

STORMWATER MANAGEMENT PLAN
APPROVED
 CITY OF WILMINGTON
 ENGINEERING DEPARTMENT
 DATE _____ PERMIT # _____
 SIGNED _____

Approved Construction Plan

Name	Date
Planning	_____
Public Utilities	_____
Traffic	_____
Fire	_____

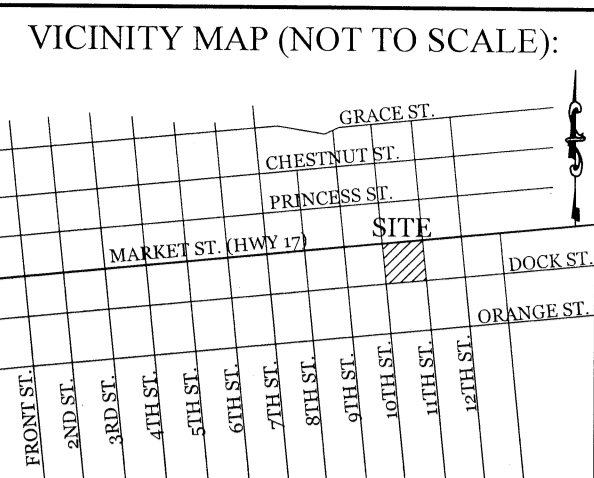

REVISIONS

No.	Description

INTRACOASTAL ENGINEERING, PLLC
 5725 Oleander Dr. Unit E-7
 Wilmington, North Carolina 28403
 Phone: (910) 859-8983
 Email: Charles@intracoastalengineering.com
 License Number P-0662

GRADING, DRAINAGE, AND STORMWATER MANAGEMENT PLAN

FOR

FAMILY FARE MARKET ST.
 WILMINGTON, NC

Charles D. Calkins
 10-21-16

CLIENT INFORMATION:

M. M. FOWLER, INC.
 LEE BARNES
 4220 NEAL ROAD
 DURHAM, NC 27705
 919-309-2925 EXT. 215

DRAWN:	BPD	SHEET SIZE:	24 x 36
CHECKED:	CDC	DATE:	10/21/2016
APPROVED:	CDC	SCALE:	1" = 20'
PROJECT NUMBER:	2015-049		

DRAWING NUMBER: C-4

4 OF 8

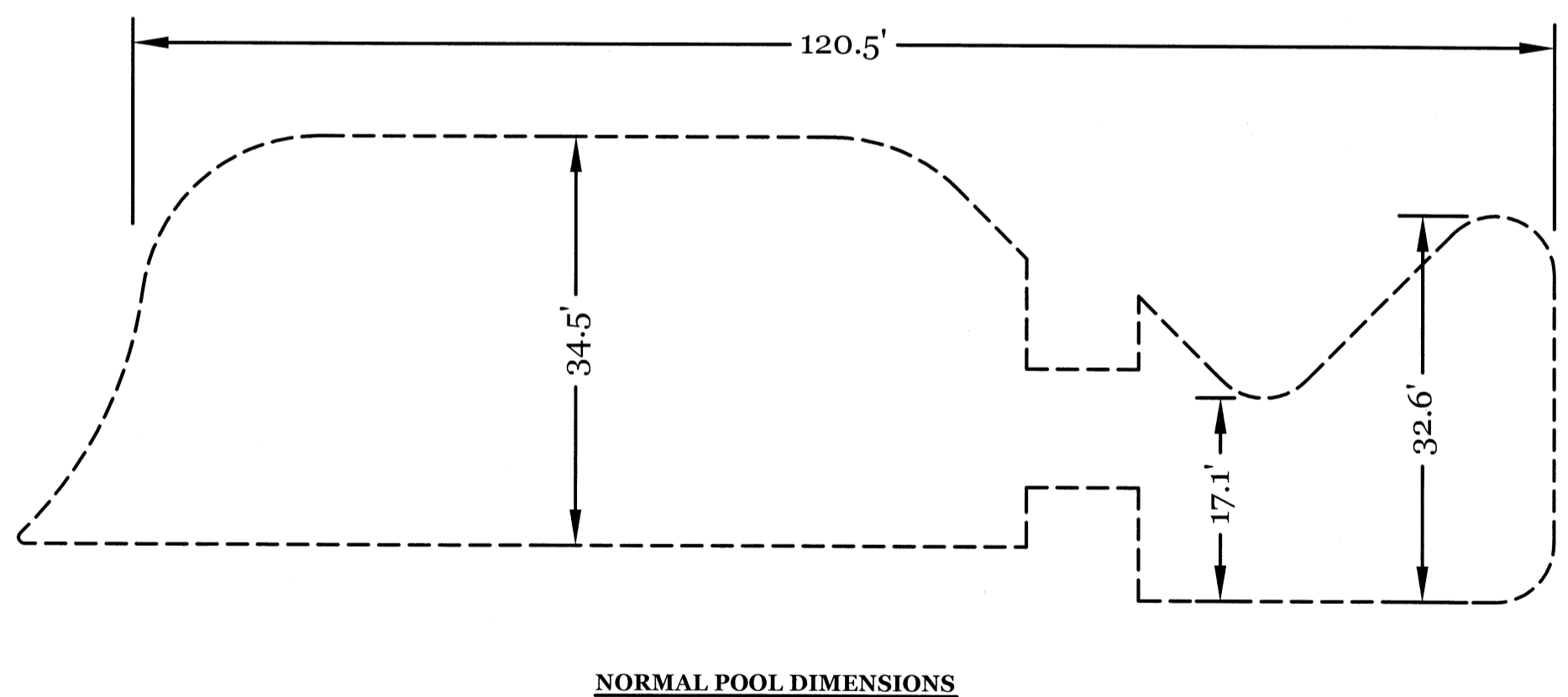
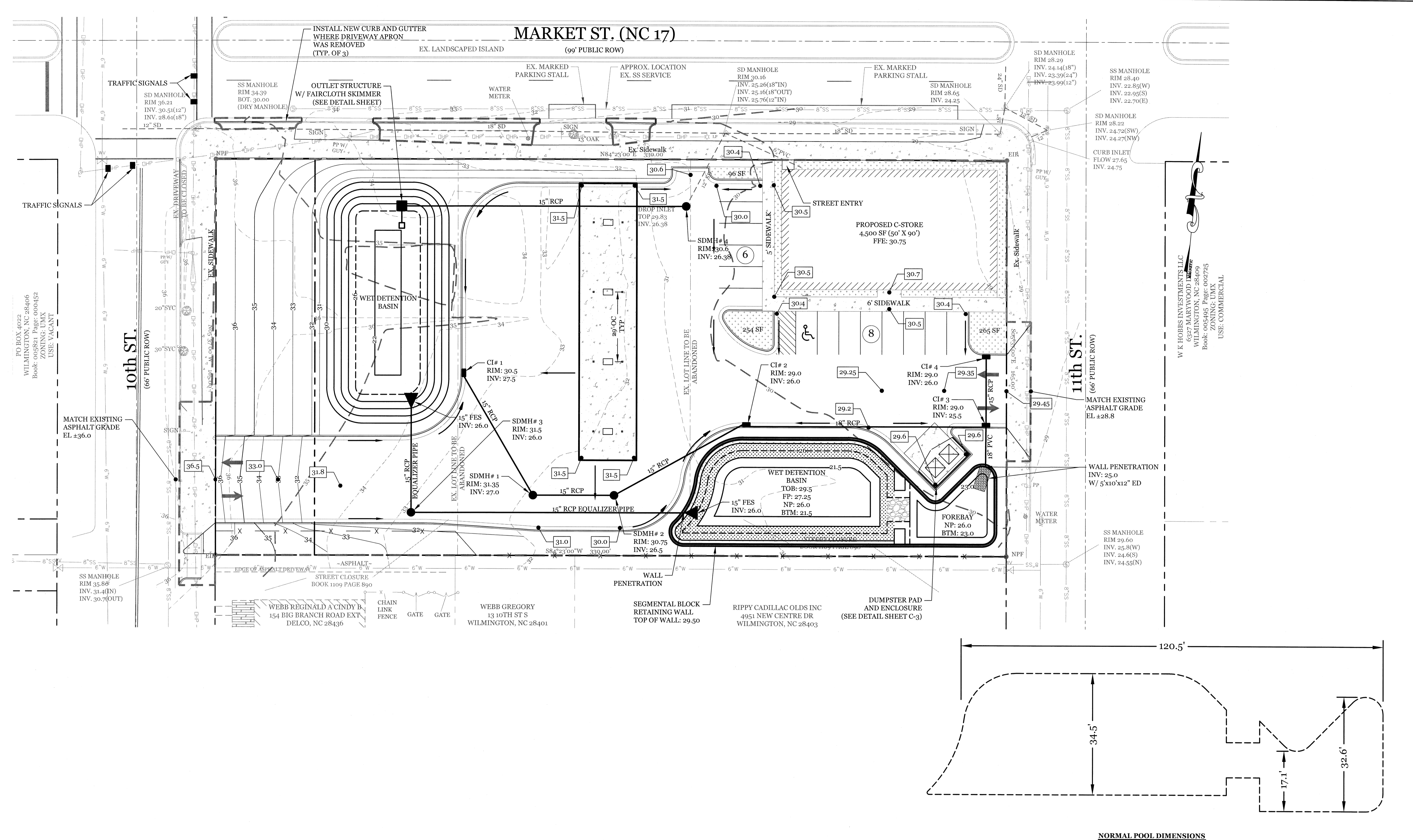

- CONSTRUCTION SEQUENCE:**
- CONSTRUCTION OF SITE TO START WITH INSTALLATION OF CONSTRUCTION ENTRANCE AND SILT FENCE ALONG ALL LOCATIONS PER PLANS. UPON INSTALLATION OF SILT FENCE, DEMOLITION OF EXISTING IMPERVIOUS PAVEMENT AND DRAINAGE STRUCTURES IDENTIFIED TO BE REMOVED MAY BEGIN. ALL SLOPED AREAS SHOULD BE SEEDDED IN ACCORDANCE TO SPECIFICATIONS. SLOPE STABILIZATION IS WITHIN 21 CALENDAR DAYS OF ANY PHASE OF CONSTRUCTION. ALL OTHER AREAS MUST BE STABILIZED WITHIN 15 WORKING DAYS. CONTRACTOR TO FOLLOW NPDES STABILIZATION REQUIREMENTS PER TABLE ON THIS SHEET AS WELL. MOST STRINGENT REQUIREMENT TO BE MET.
 - GENERAL CLEARING AND GRADING OF THIS SITE WILL NOT BE DONE UNTIL THE TEMPORARY SILT FENCE & CONSTRUCTION ENTRANCE HAS BEEN INSTALLED.
 - NO CUT SLOPE OR FILL SLOPE SHALL EXCEED A RISE OR FALL OF ONE FOOT FOR EVERY RUN OF 3 FEET (1 VERTICAL TO 3 HORIZONTAL).
 - NO SEDIMENT WILL BE ALLOWED TO EXIT THE SITE. ALL EROSION SHALL BE CONTROLLED INCLUDING SIDE SLOPES DURING AND AFTER CONSTRUCTION.
 - INSTALL PRIMARY EROSION CONTROL MEASURES BEFORE BEGINNING CONSTRUCTION INCLUDING BUT NOT LIMITED TO GRAVELED CONSTRUCTION ENTRANCE, SILT FENCE, TREE PROTECTION FENCE & SEDIMENT BASINS. CONTRACTOR TO BE FAMILIAR WITH USACE GENERAL PERMIT CONDITIONS FOR ROAD CROSSINGS. SPECIFIC CONSTRUCTION METHODS MAY BE REQUIRED ABOVE AND BEYOND WHAT IS SPECIFIED IN THIS PLAN. INSTALL ALL SECONDARY EROSION CONTROL MEASURES, SUCH AS INLET PROTECTION AS SOON AS POSSIBLE AFTER BEGINNING CONSTRUCTION.
 - ALL EROSION CONTROL MEASURES TO BE INSPECTED AFTER EACH RAIN. SILT FENCE AND INLET PROTECTION TO BE CLEANED WHEN HALF FULL.
 - A 4" LAYER OF TOPSOIL SHALL BE APPLIED TO ALL NEW AREAS TO BE GRASSED.
 - MAINTAIN ALL EROSION CONTROL MEASURES UNTIL PROJECT IS COMPLETE.
 - MORE STRINGENT MEASURES MAY BE REQUIRED TO HALT EROSION IF THOSE ON THIS PLAN PROVE TO BE LESS EFFECTIVE.
 - REMOVE ALL TEMPORARY EROSION CONTROL MEASURES UPON COMPLETION OF CONSTRUCTION. ALL PERMANENT MEASURES SHALL BE WELL ESTABLISHED PRIOR TO PROJECT COMPLETION.

- MAINTENANCE PLAN:**
- ALL EROSION AND SEDIMENT CONTROL PRACTICES WILL BE CHECKED FOR STABILITY AND OPERATION FOLLOWING EVERY RUNOFF-PRODUCING RAINFALL, BUT IN NO CASE, LESS THAN ONCE EVERY WEEK AND WITHIN 24 HOURS OF EVERY HALF INCH RAINFALL.
 - ALL POINTS OF EGRESS WILL HAVE CONSTRUCTION ENTRANCES THAT WILL BE PERIODICALLY TOP-DRESSED WITH AN ADDITIONAL 2 INCHES OF 2-3 INCH STONE TO MAINTAIN PROPER DEPTH. THEY WILL BE MAINTAINED IN A CONDITION TO PREVENT MUD OR SEDIMENT FROM LEAVING THE SITE. IMMEDIATELY REMOVE OBJECTIONABLE MATERIAL SPILLED, WASHED OR TRACKED ONTO THE CONSTRUCTION ENTRANCE OR ROADWAYS.
 - SEDIMENT WILL BE REMOVED FROM HARDWARE CLOTH AND GRAVEL INLET PROTECTION, ROCK DOUGHNUT INLET PROTECTION, SEDIMENT TRAP Baffles, AND ROCK PIPE INLET PROTECTION WHEN THE DESIGNED STORAGE CAPACITY HAS BEEN HALF FILLED WITH SEDIMENT. ROCK WILL BE CLEANED OR REPLACED WHEN THE SEDIMENT POOL NO LONGER DRAINS AS DESIGNED. DEBRIS WILL BE REMOVED FROM THE ROCK AND HARDWARE CLOTH TO ALLOW PROPER DRAINAGE. SILT SACKS WILL BE EMPTIED ONCE A WEEK AND AFTER EVERY RAIN EVENT. SEDIMENT WILL BE REMOVED FROM AROUND BEAVER DAMS, DANDY SACKS AND SOCKS ONCE A WEEK AND AFTER EVERY RAIN EVENT.
 - CHECK SEDIMENT BASIN AND Baffles WEEKLY & AFTER EACH RAINFALL EVENT. REMOVE SEDIMENT FROM TRAP & Baffles AND RESTORE TO ORIGINAL VOLUME WHEN SEDIMENT ACCUMULATES TO ABOUT 1/2 THE DESIGN VOLUME. REPAIR/REPLACE Baffles IF TORN, COLLAPSED, OR INEFFECTIVE.
 - DIVERSION DITCHES WILL BE CLEANED OUT IMMEDIATELY TO REMOVE SEDIMENT OR OBSTRUCTIONS FROM THE FLOW AREA. THE DIVERSION RIDGES WILL ALSO BE REPAIRED. SWALES MUST BE TEMPORARILY STABILIZED WITHIN 21 CALENDAR DAYS OF CEASE OF ANY PHASE OF ACTIVITY ASSOCIATED WITH A SWALE. SEDIMENT WILL BE REMOVED FROM BEHIND THE SEDIMENT FENCE WHEN IT BECOMES HALF FILLED. THE SEDIMENT FENCE WILL BE REPAIRED AS NECESSARY TO MAINTAIN A BARRIER. STAKES MUST BE STEEL. STAKE SPACING WILL BE 6 FEET MAX. WITH THE USE OF EXTRA STRENGTH FABRIC, WITHOUT WIRE BACKING. STAKE SPACING WILL BE 8 FEET MAX WHEN STANDARD STRENGTH FABRIC AND WIRE BACKING ARE USED. IF ROCK FILTERS ARE DESIGNED AT LOW POINTS IN THE IN THE SEDIMENT FENCE THE ROCK WILL BE REPAIRED OR REPLACED IF IT BECOMES HALF FULL OF SEDIMENT, NO LONGER DRAINS AS DESIGNED OR IS DAMAGED.

- SURVEY NOTES:**
- THE SURVEY INFORMATION SHOWN ON THIS PLAN IS FROM A FIELD SURVEY COMPLETED IN JUNE 2016 BY MICHAEL UNDERWOOD AND ASSOCIATES, PA.
 - NO SIGNIFICANT TREES EXIST ON SITE.
- DEVELOPMENT NOTES:**
- ALL DEVELOPMENT SHALL BE IN ACCORDANCE WITH CITY OF WILMINGTON ZONING ORDINANCE.
 - PROJECT SHALL COMPLY WITH ALL FEDERAL, STATE & NEW HANOVER COUNTY REGULATIONS.
 - PROPERTY IS LOCATED IN ZONE "X" ACCORDING TO THE FEMA FLOOD INSURANCE RATE MAP, 3720312700J COMMUNITY-PANEL NUMBER 3127, DATED 04/03/06.

Approved Construction Plan

Name	Date
Planning	_____
Public Utilities	_____
Traffic	_____
Fire	_____

STORMWATER MANAGEMENT PLAN

APPROVED

CITY OF WILMINGTON
 ENGINEERING DEPARTMENT

DATE _____ PERMIT # _____
 SIGNED _____

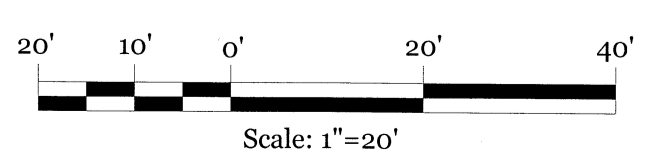
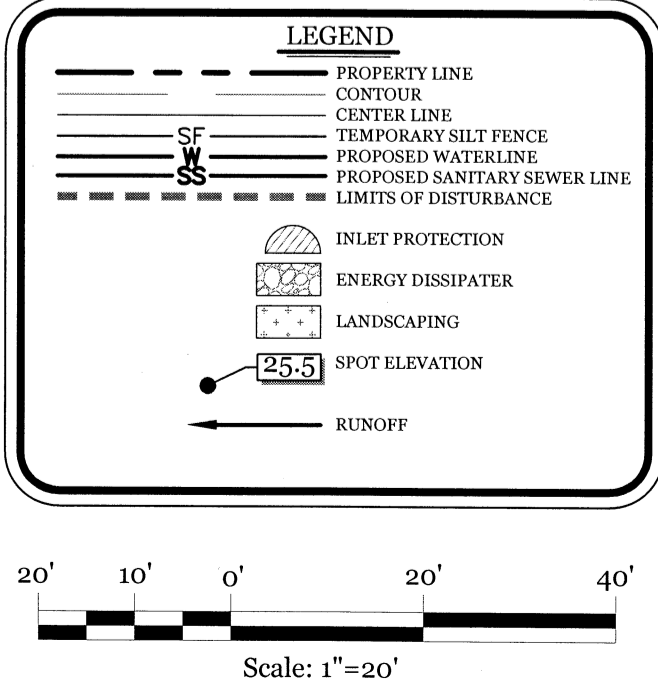

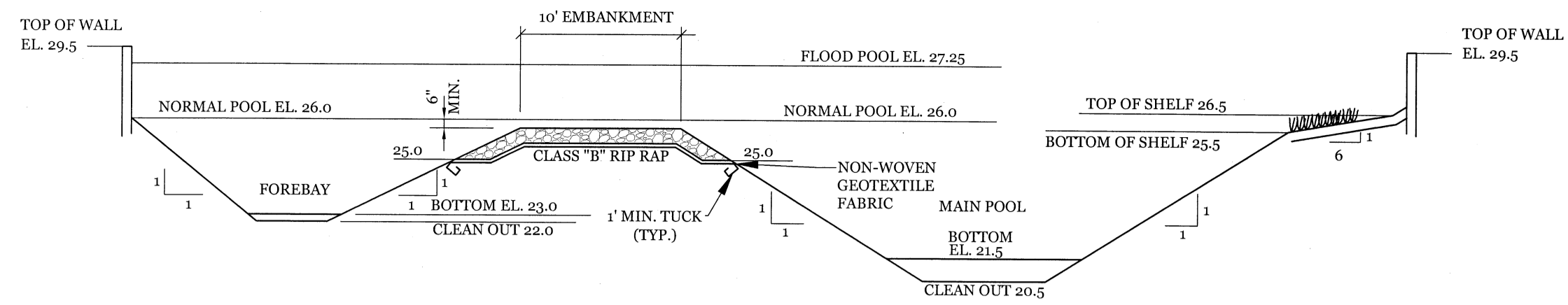

- POND SLOPE TO BE SEEDED IN ACCORDANCE TO SEEDING SPECIFICATIONS
- 6:1 VEGETATED SLOPE TO BE PLANTED WITH WETLAND SPECIES I.E. PICKEREL WEED, DUCK POTATO, SWAMP ROSE, BLUE FLAG, & CARDINAL FLOWER. (OR ENGINEER APPROVED ALTERNATIVE)
- VEGETATED SLOPE SHALL BE PLANTED WITH PLUGS OR POTS AT 24" O.C. IN A CHECKERBOARD PATTERN.
- VEGETATED SLOPE PLANTING SHALL NOT BE PLANTED WITHIN 10' OF THE OUTLET STRUCTURES.
- A PUMP WILL BE PROVIDED TO DRAIN THE BASIN FOR MAINTENANCE AND EMERGENCIES

DETENTION POND & FOREBAY SECTION
NTS

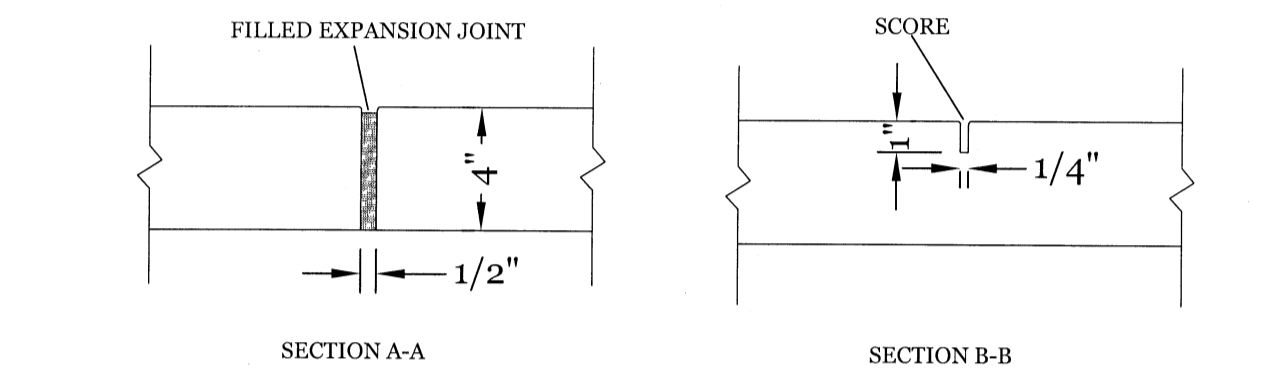
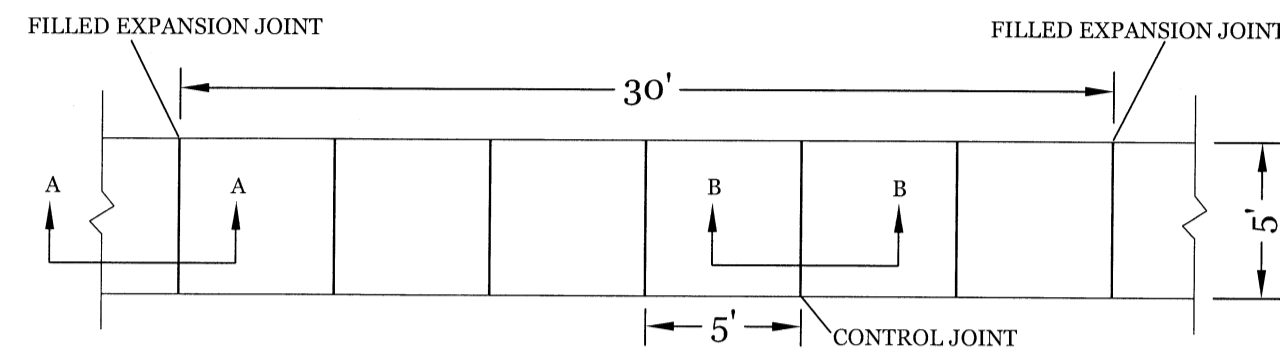

- NOTES:
1. JOINT MATERIAL TO COMPLY WITH CURRENT NCDOT STANDARDS.
 2. SANITARY SEWER CLEAN-OUTS, WATER METERS, MANHOLES, AND VALVE LIDS TO BE LOCATED OUTSIDE SIDEWALK WHERE FEASIBLE.
 3. MINIMUM SIDEWALK WIDTH TO BE 6' MINIMUM IF PLACED AT BACK OF CURB.
 4. CONCRETE FOR ALL SIDEWALKS (EXCEPT ANY PORTION CONTAIN WITHIN A DRIVEWAY APRON) SHALL BE CLASS "A" - 3,000 PSI.
 5. MINIMUM REPLACEMENT FOR REPAIRS IS A 5' X 5' PANEL.
 6. 2" STONE BASE MAY BE REQUIRED FOR POOR SOIL CONDITIONS.
 7. MINIMUM DEPTH FOR TUNNELING BELOW SIDEWALK IS 12"
 8. MAX ADJACENT GROUND SLOPE WITHOUT RAILING IS 2:1
 9. MIN GRADE FOR PROPER DRAINAGE IS 1% IN AT LEAST 1 DIRECTION. MAX CROSS SLOPE IS 2%. MAX LONGITUDINAL SLOPE IS 8.3%, 10% IF LIMITED BY EXISTING CONDITIONS, OR NO GREATER THAN THE SLOPE OF THE EXISTING ADJACENT ROAD.

STANDARD SIDEWALK DETAIL (SD 3-10)
NTS

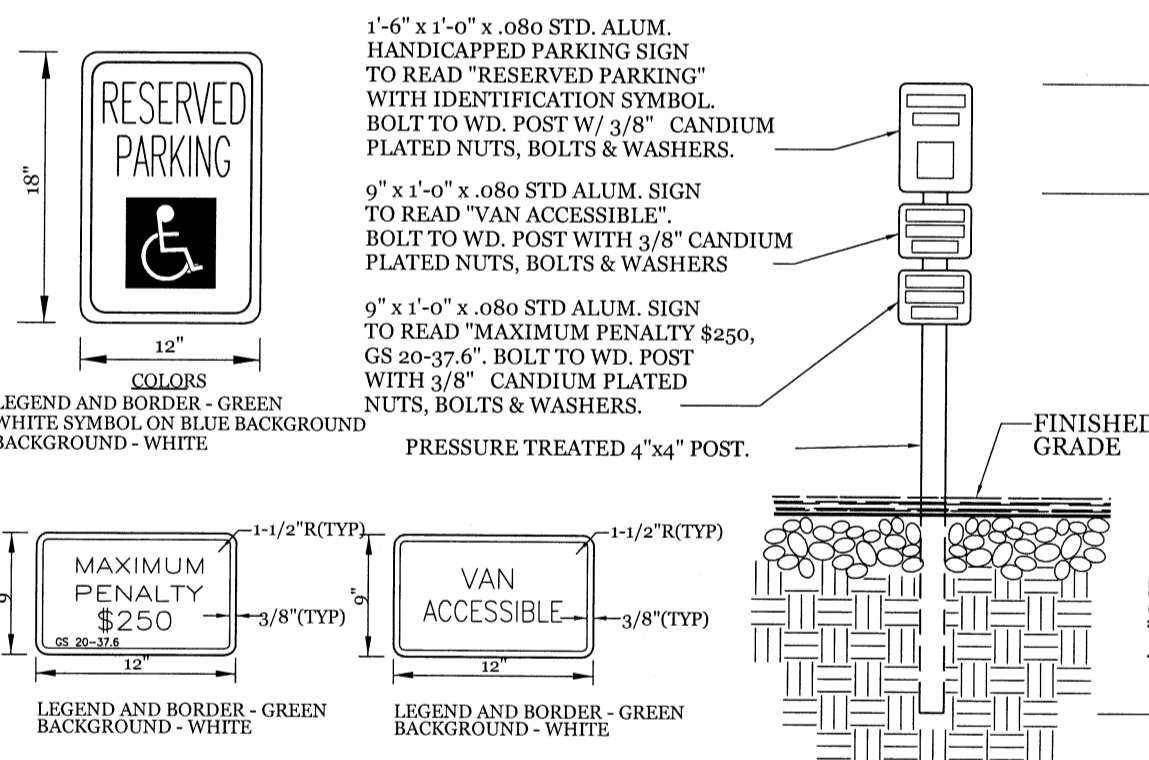

TYPICAL HANDICAPPED SIGN DETAIL
NTS

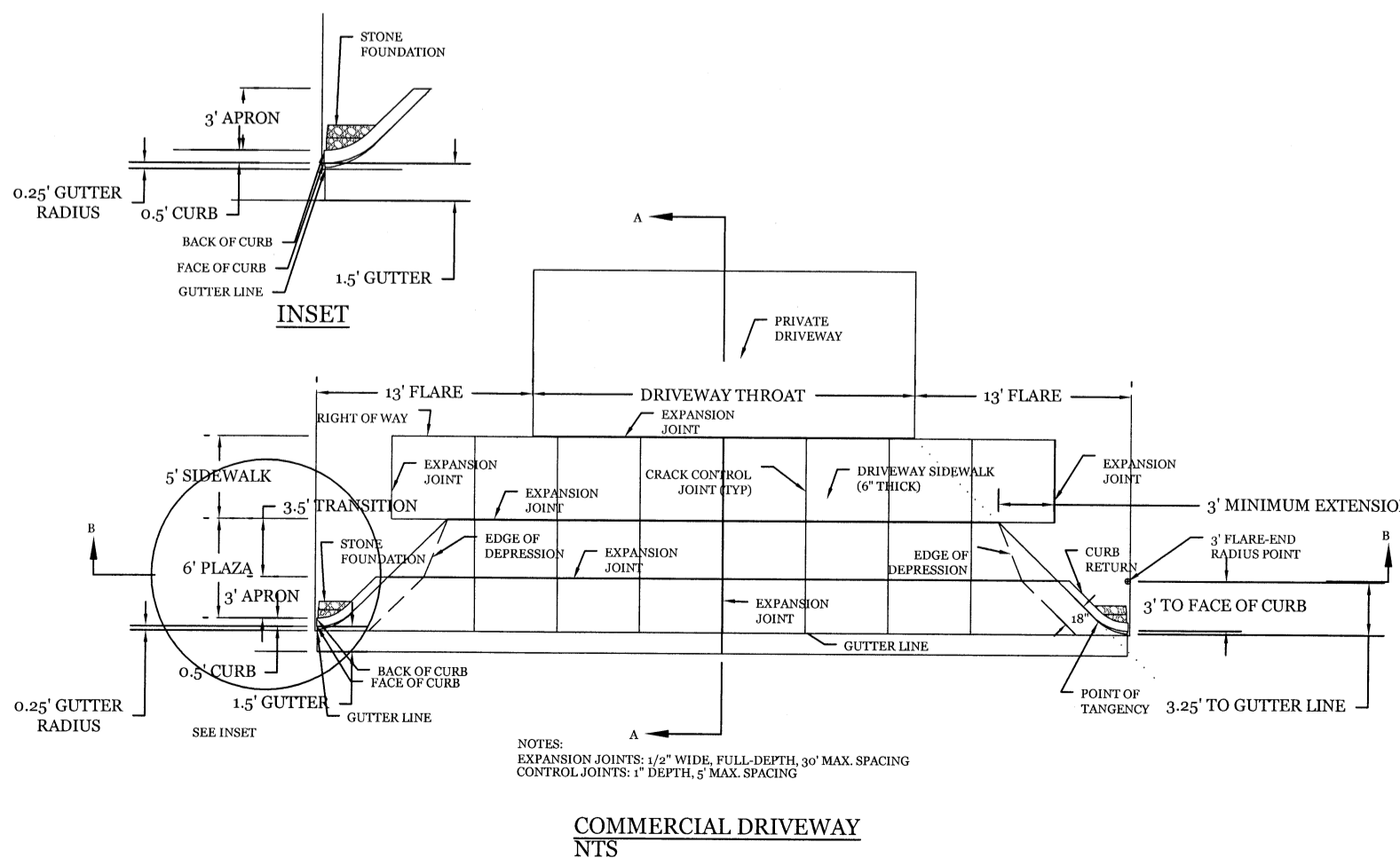

COMMERCIAL DRIVEWAY
NTS

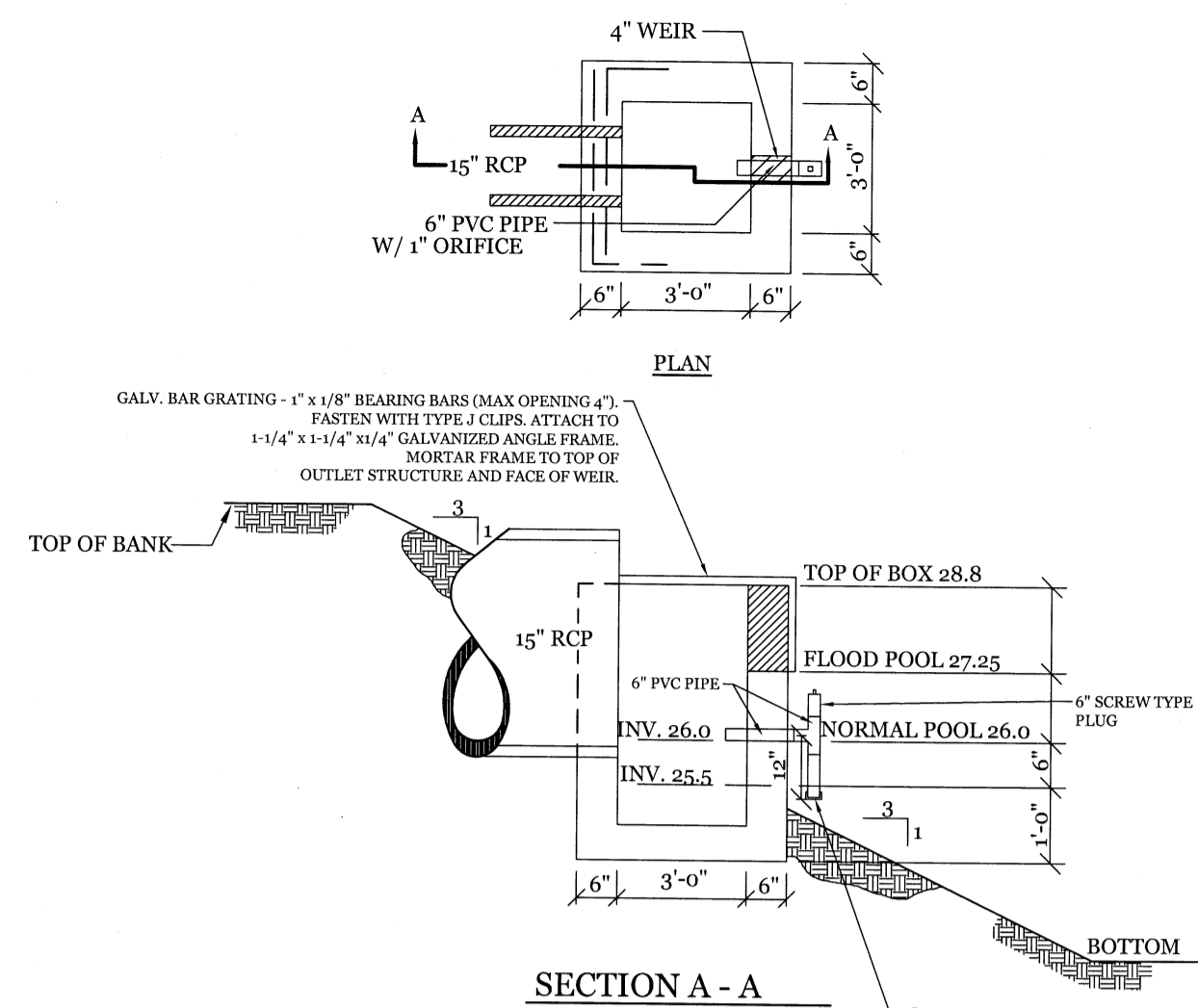

DETENTION POND OUTLET STRUCTURE
NTS

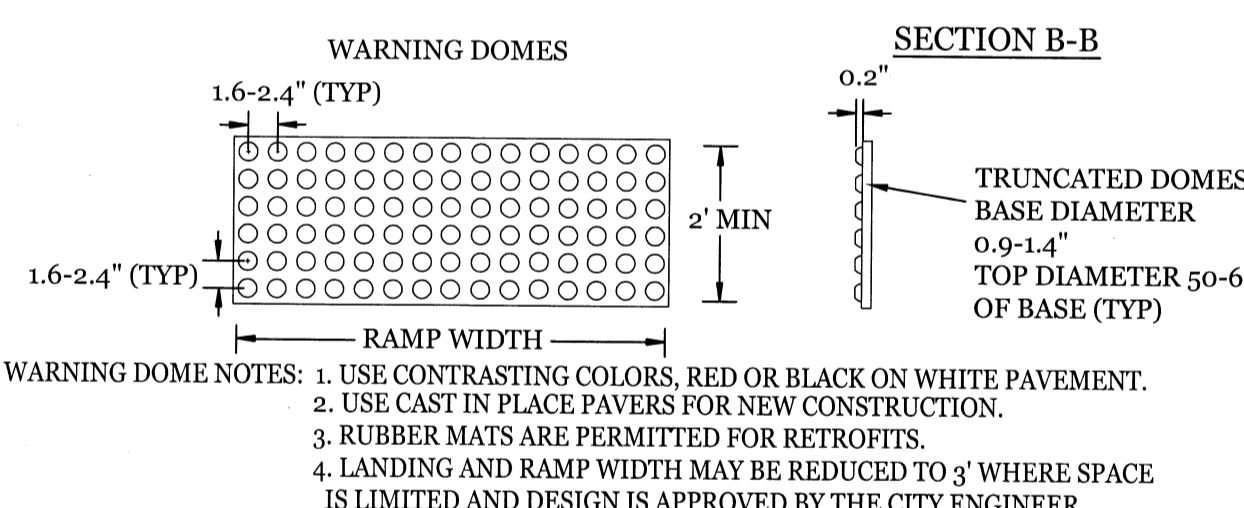
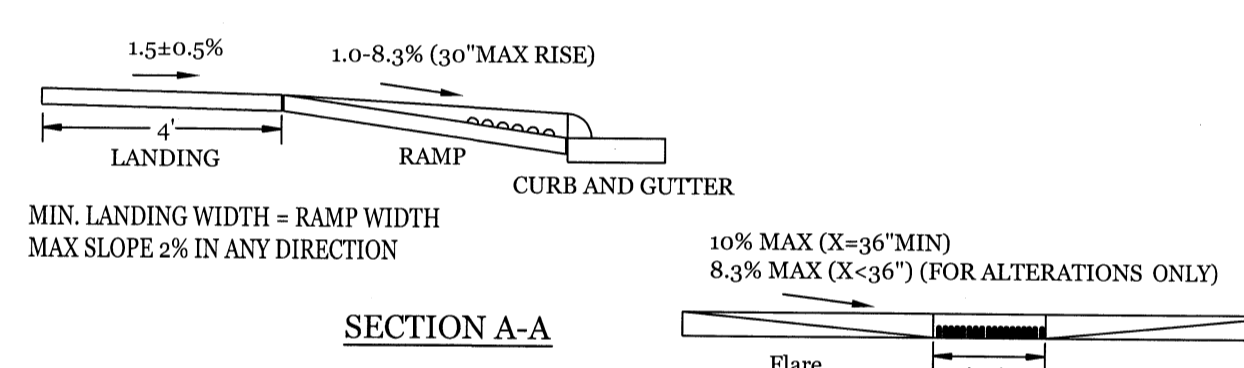
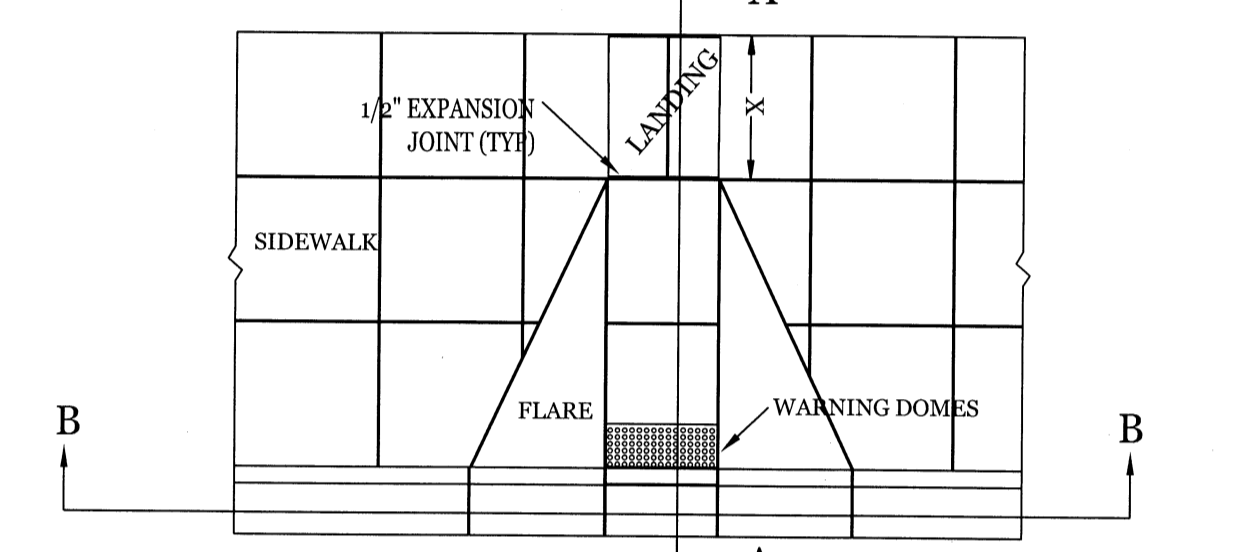

WHEEL CHAIR RAMP DETAIL
NTS

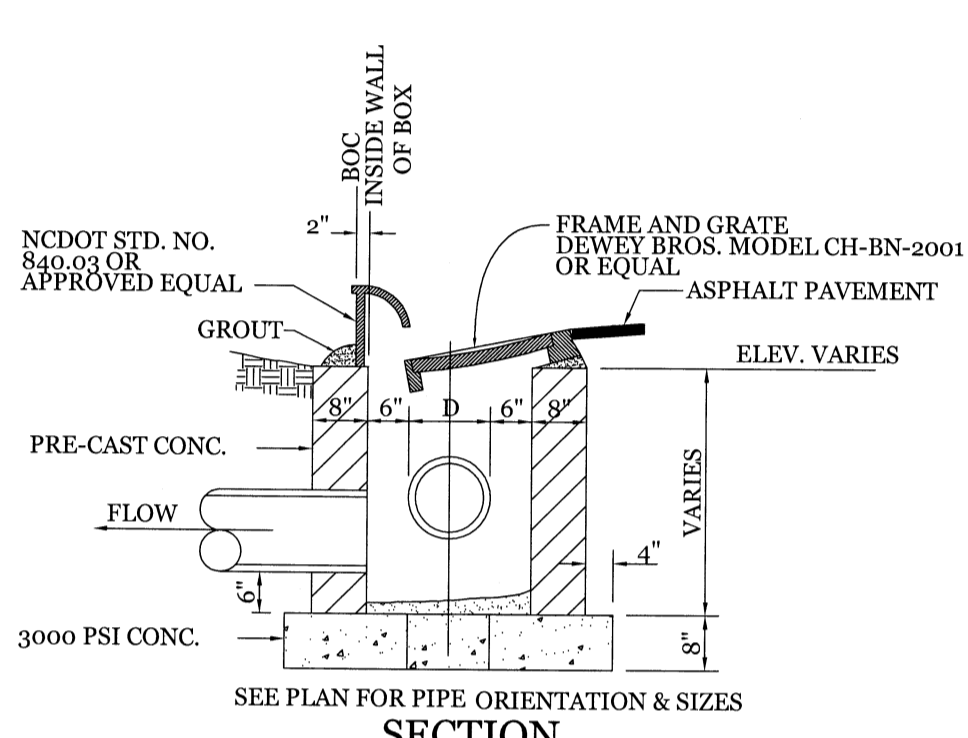
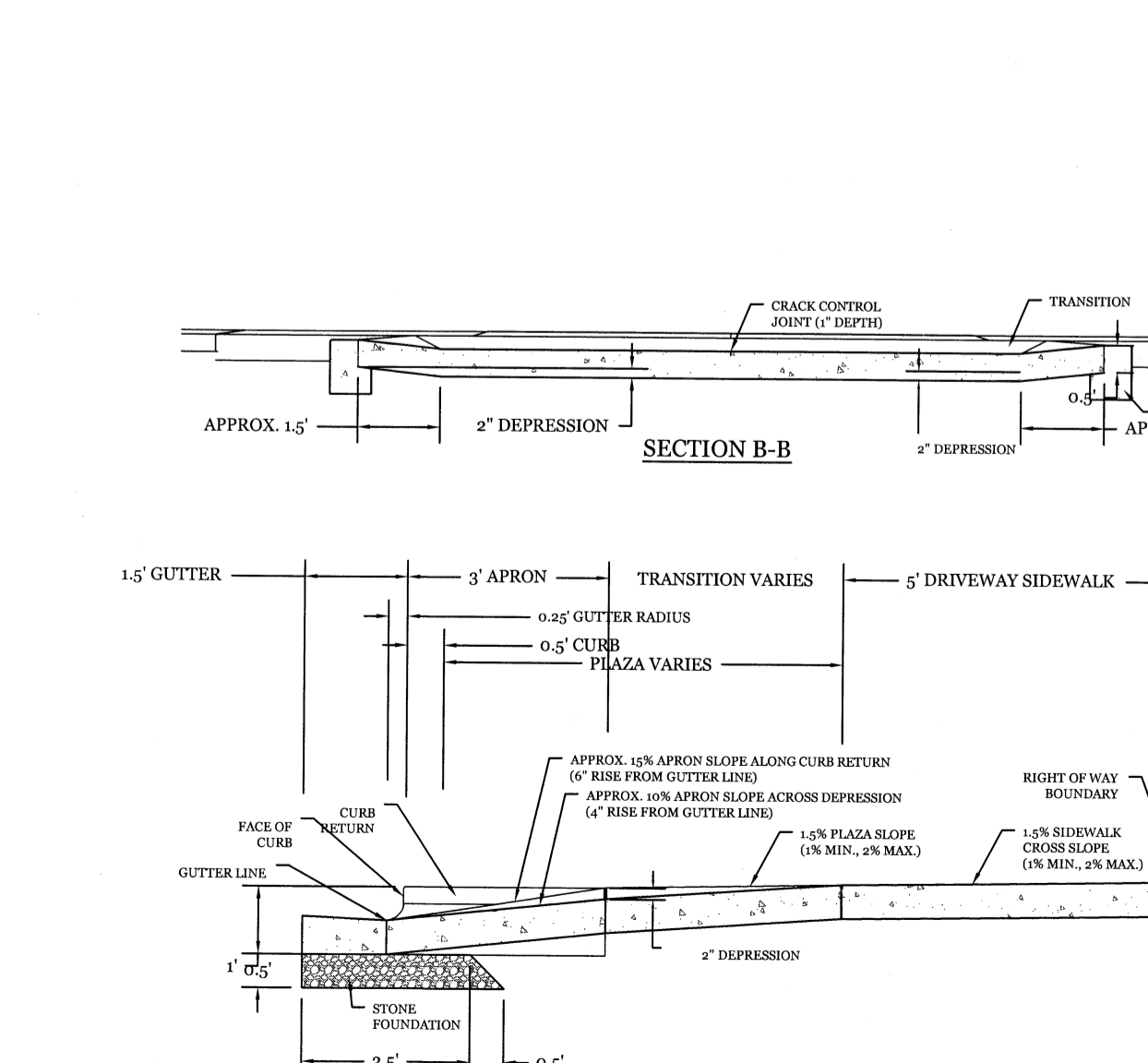

CURB INLET DETAIL
NTS

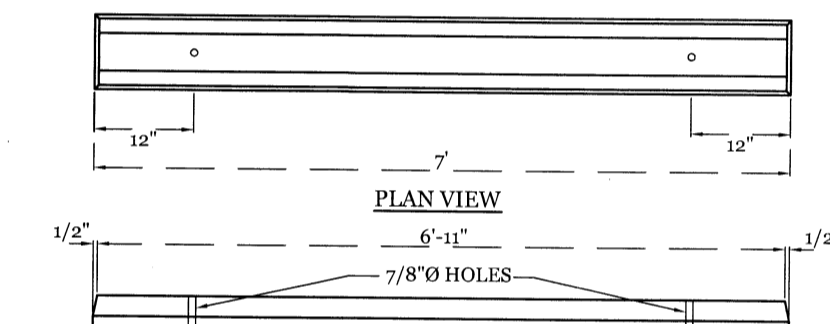

WHEEL STOP DETAIL
NTS

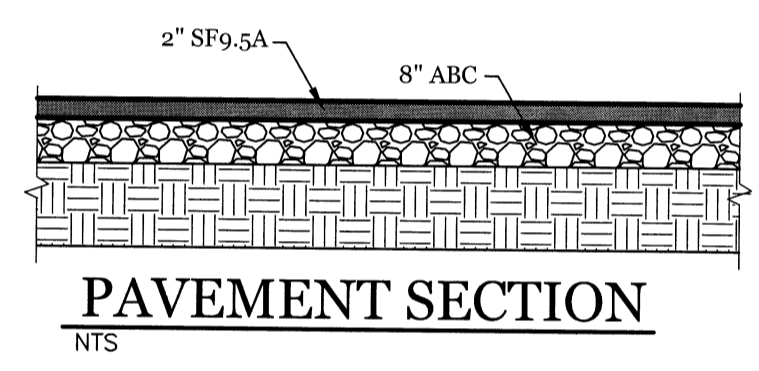

PAVEMENT SECTION
NTS

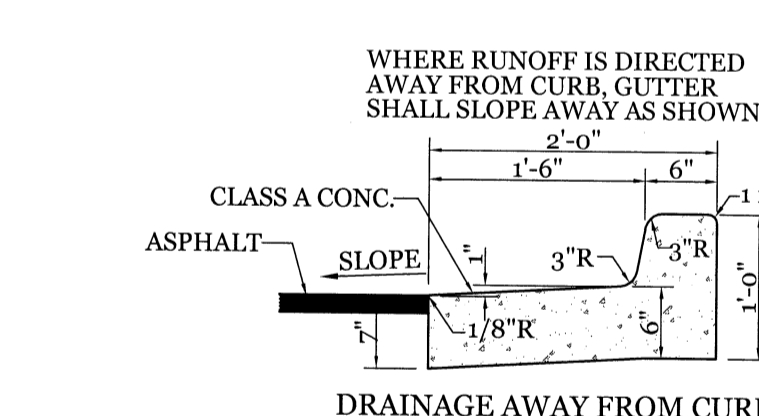

DRAINAGE AWAY FROM CURB
NTS

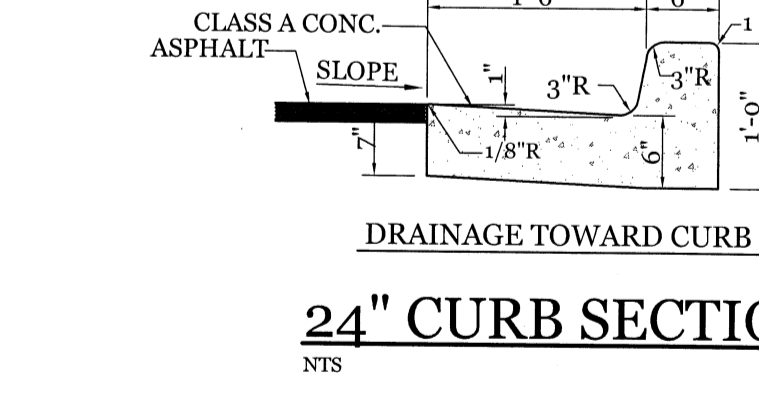

24\"/>

SITE WORK NOTES:

1. THE CONTRACTOR SHALL VISIT THE SITE AND BECOME FAMILIAR WITH EXISTING CONDITIONS BOTH ON AND ADJACENT TO THE SITE.
2. CLEARING: CONTRACTOR SHALL REMOVE ALL TREES AND VEGETATION WITHIN LIMITS OF CONSTRUCTION UNLESS OTHERWISE DESIGNATED TO REMAIN.
3. GRUBBING AND STRIPPING: CONTRACTOR SHALL RAKE AND REMOVE ROOTS, STUMPS, VEGETATION, DEBRIS, EXISTING STRUCTURES ABOVE AND BELOW GRADE, ORGANIC MATERIAL OR ANY OTHER UNSUITABLE MATERIAL WITHIN LIMITS OF CONSTRUCTION.
4. MUCKING: CONTRACTOR SHALL COORDINATE WITH OWNER AND THEIR GEOTECHNICAL REPRESENTATIVE TO COORDINATE REMOVAL OF ANY SOFT AREAS.
5. DISPOSAL: CLEARED, GRUBBED, STRIPPED OR OTHER WASTE MATERIAL SHALL BE REMOVED FROM SITE AND DISPOSED OF IN A PROPERLY PERMITTED FACILITY.
6. FILL AND COMPACTION SHOULD COMPLY WITH GEOTECHNICAL RECOMMENDATIONS.
7. THE CONTRACTOR SHALL NOTE THAT THE GRADING PLAN MAY NOT REPRESENT A BALANCED EARTHWORK CONDITION. THE CONTRACTOR SHALL BE RESPONSIBLE FOR CUT AND FILL QUANTITIES AND COMPLETE INSTALLATION TO SPECIFIED GRADES.
8. THE CONTRACTOR SHALL FURNISH SUITABLE BORROW MATERIAL FROM AN OFF-SITE PROPERLY PERMITTED FACILITY AS REQUIRED.
9. INFORMATION CONCERNING UNDERGROUND UTILITIES WAS OBTAINED FROM AVAILABLE RECORDS. IT SHALL BE THE RESPONSIBILITY OF THE CONTRACTOR TO DETERMINE THE EXACT ELEVATIONS AND LOCATIONS OF ALL EXISTING UTILITIES AT ALL CROSSINGS PRIOR TO COMMENCING TRENCH EXCAVATION. IF ACTUAL CLEARANCES ARE LESS THAN INDICATED ON PLAN, THE CONTRACTOR SHALL CONTACT THE DESIGN ENGINEER BEFORE PROCEEDING WITH CONSTRUCTION. ANY CONDITION DISCOVERED OR EXISTING THAT WOULD NECESSITATE A MODIFICATION OF THESE PLANS SHALL BE BROUGHT TO THE ATTENTION OF THE DESIGN ENGINEER BEFORE PROCEEDING WITH CONSTRUCTION. NO CONSTRUCTION IS TO BEGIN BEFORE LOCATION OF EXISTING UTILITIES HAS BEEN DETERMINED. CALL "NO ONE-CALL" AT LEAST 48 HOURS BEFORE COMMENCING CONSTRUCTION.
10. THE CONTRACTOR IS RESPONSIBLE FOR THE LOCATION AND PROTECTION OF ALL EXISTING UTILITIES DURING CONSTRUCTION. BEFORE COMMENCING ANY EXCAVATIONS IN OR ALONG ROADWAYS OR RIGHT-OF-WAYS, PUBLIC AREAS OR IN PRIVATE EASEMENTS, THE CONTRACTOR SHALL NOTIFY ALL APPROPRIATE PERSONNEL OF THEIR INTENT TO EXCAVATE, IN WRITING, NOT LESS THAN 10 DAYS PRIOR TO EXCAVATING.
11. THE CONTRACTOR SHALL BE RESPONSIBLE TO COORDINATE DISCONNECTION/ RECONNECTION AND/OR THE RELOCATION OF ALL EXISTING UTILITIES WITH APPROPRIATE PERSONNEL.
12. CONTRACTOR SHALL ADJUST ALL DIMENSIONS AT THE SITE. FURTHERMORE THE CONTRACTOR SHALL REPORT ALL DISCREPANCIES OR QUESTIONS TO THE ENGINEER PRIOR TO INSTALLATION.
13. THE CONTRACTOR SHALL PROVIDE ANY AND ALL LAYOUT REQUIRED TO CONSTRUCT HIS WORK UNLESS OTHERWISE DIRECTED BY OWNER.
14. ALL SERVICE CONNECTIONS SHALL BE INSTALLED TO MEET ALL LOCAL, STATE, AND CFPWA CODES. METERS, TAPS, MATERIALS, WORKMANSHIP AND ALL FEES SHALL BE THE RESPONSIBILITY OF THE CONTRACTOR AND SHALL COMPLY WITH ALL REQUIREMENTS.
15. ALL BACKFILL FROM UTILITY INSTALLATION MUST BE COMPACTED OR AMENDED TO PROVIDE TRAFFIC BEARING CAPACITY. GEOTECHNICAL ENGINEER TO BE CONSULTED AT CONTRACTORS COST AS NECESSARY.
16. ALL AREAS SHALL BE GRADED FOR POSITIVE DRAINAGE. CONTRACTOR SHALL REPORT ANY DISCREPANCIES TO THE ENGINEER PRIOR TO INSTALLATION. ALL AREAS SHALL BE SLOPED TO DRAIN AWAY FROM BUILDINGS AT ALL TIMES. CONCRETE FOR WALKS, CURBS AND DRIVES SHALL HAVE A MINIMUM COMPRESSIVE STRENGTH OF 3000 PSI @ 28 DAYS - AIR ENTRAINED.
17. FIELD TESTING SHALL BE DONE BY AN INDEPENDENT TESTING LABORATORY PAID FOR BY THE OWNER. FURTHER TESTING REQUIRED DUE TO A FAILED TEST WILL BE PAID FOR BY THE CONTRACTOR.
18. ALL SIDEWALKS SHALL BE FREE OF CRACKS, BREAKS, OR ANY OTHER DEFECT PRIOR TO RECEIVING A CERTIFICATE OF OCCUPANCY.

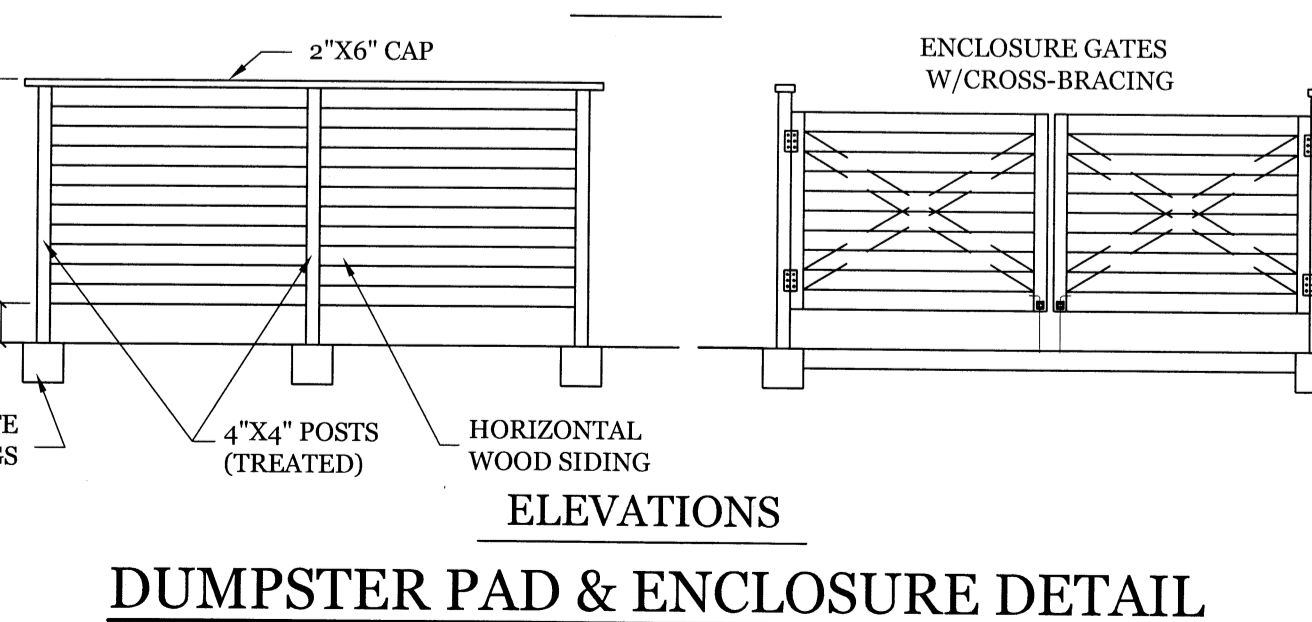
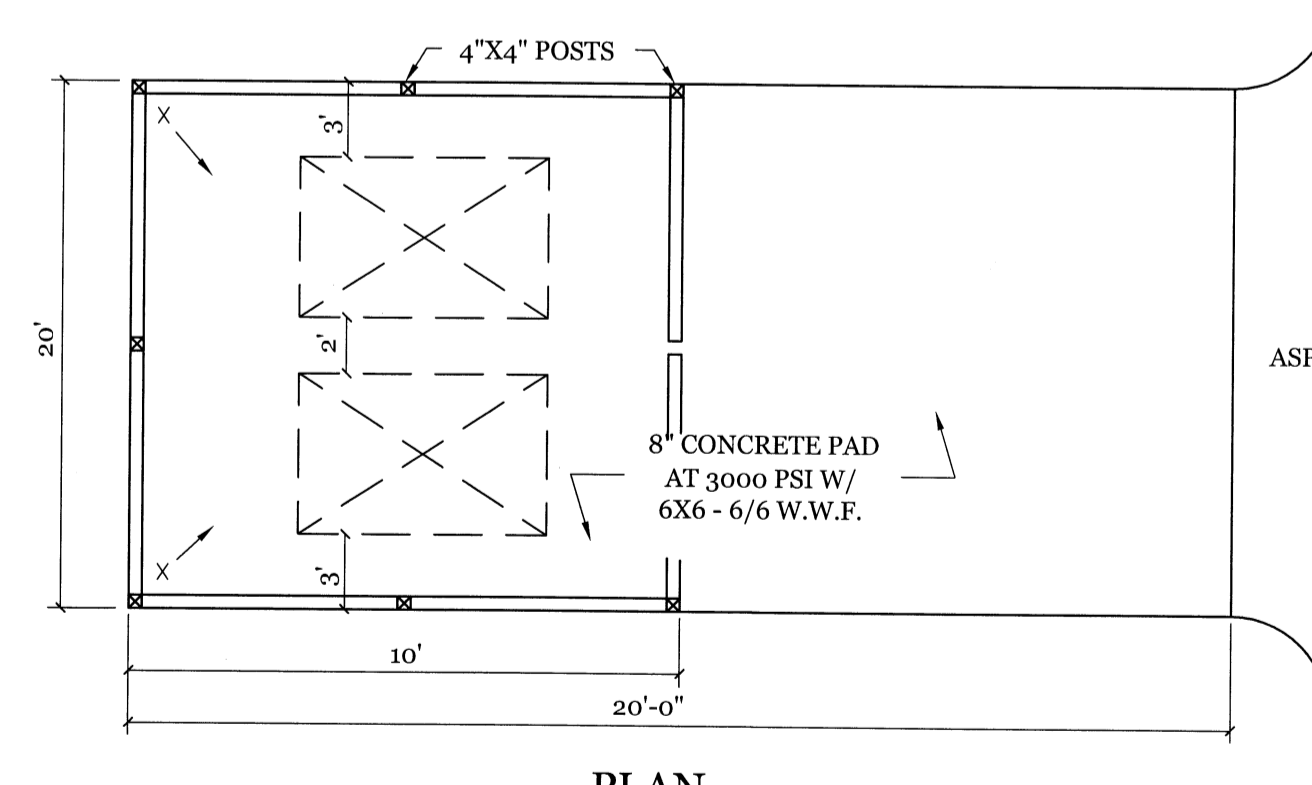

DUMPSTER PAD & ENCLOSURE DETAIL
NTS

STORMWATER MANAGEMENT PLAN
APPROVED
CITY OF WILMINGTON
ENGINEERING DEPARTMENT
DATE _____ PERMIT # _____
SIGNED _____

Approved Construction Plan

Name	Date
Planning	
Public Utilities	
Traffic	
Fire	

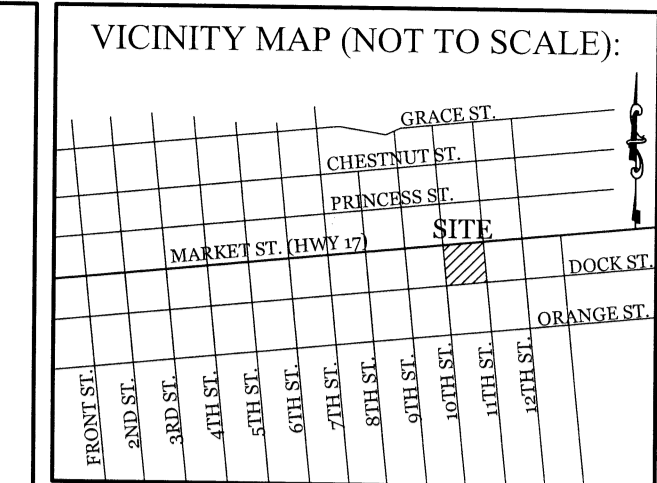

REVISIONS

No.	Description

INTRACOASTAL ENGINEERING, PLLC
5725 Olander Dr. Unit E-7
Wilmington, North Carolina 28403
Phone: (910) 859-8983
Email: charlie@intracoastalengineering.com
License Number P-0662

DETAILS FOR
FAMILY FARE MARKET ST.
WILMINGTON, NC

NORTH CAROLINA PROFESSIONAL SEAL
032555
ENGINEER
CHARLES D. CHAIKIN
Charles D. Chaikin
10/21/16

CLIENT INFORMATION:
M. M. FOWLER, INC.
LEE BARNES
4220 NEAL ROAD
DURHAM, NC 27705
919-309-2925 EXT. 215

DRAWN: BPD	SHEET SIZE: 24 x 36
CHECKED: CDC	DATE: 10/21/2016
APPROVED: CDC	SCALE: NTS
PROJECT NUMBER: 2015-049	

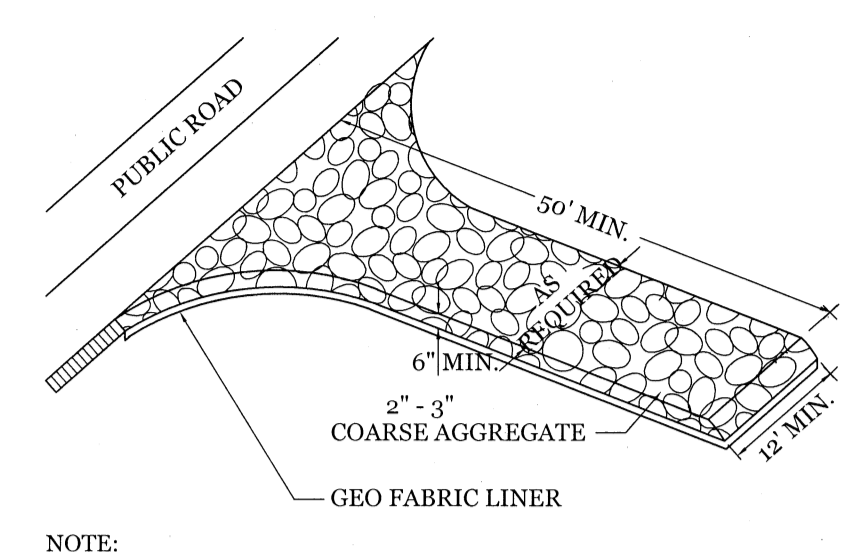

NOTE:
CONSTRUCTION ENTRANCE TO BE 12' OR ENTIRE WIDTH OF ENTRANCE, WHICHEVER IS GREATER.

TEMPORARY GRAVEL CONSTRUCTION ENTRANCE
NTS

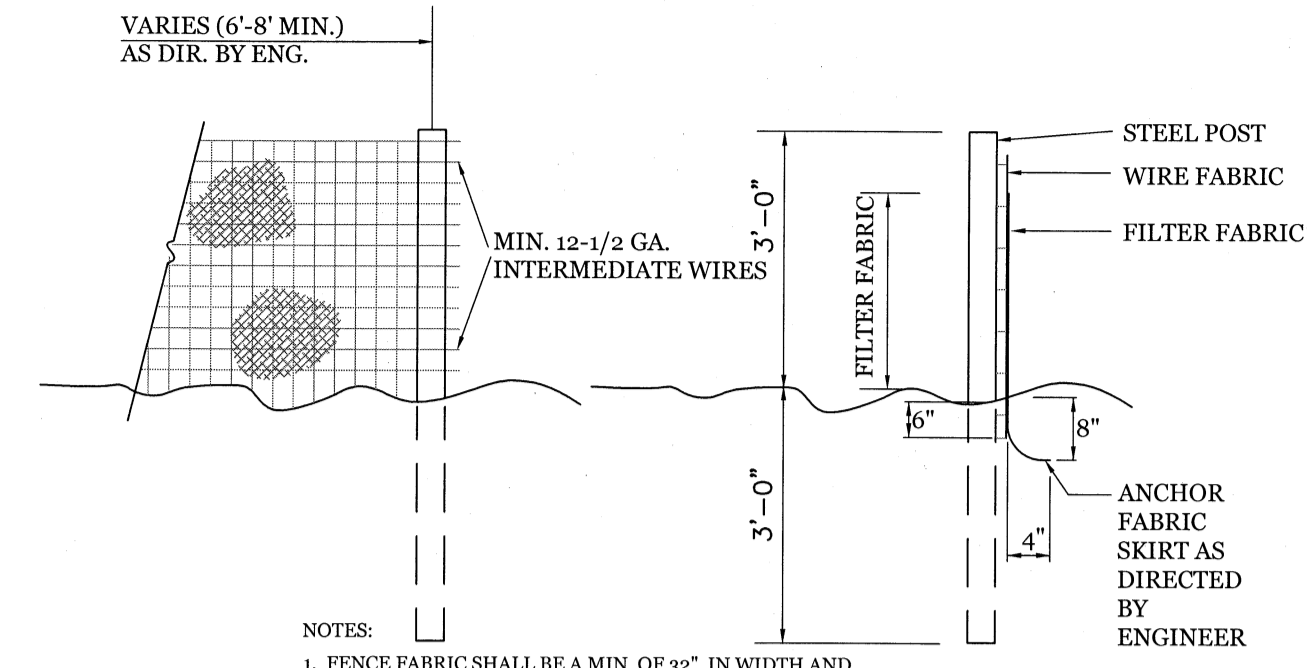

NOTES:
1. FENCE FABRIC SHALL BE A MIN. OF 32" IN WIDTH AND SHALL HAVE A MIN. OF SIX LINE WIRES WITH 12" STAY SPACING.
2. FABRIC SHALL BE FOR EROSION CONTROL AND MIN. OF 90" IN WIDTH. FABRIC SHALL BE FASTENED ADEQUATELY TO THE WIRE FABRIC AS DIRECTED BY THE ENGINEER.
3. STEEL POST SHALL BE 2" IN HEIGHT AND BE OF THE SELF-FASTENER STEEL ANGLE TYPE.

TEMPORARY SILT FENCE
NTS

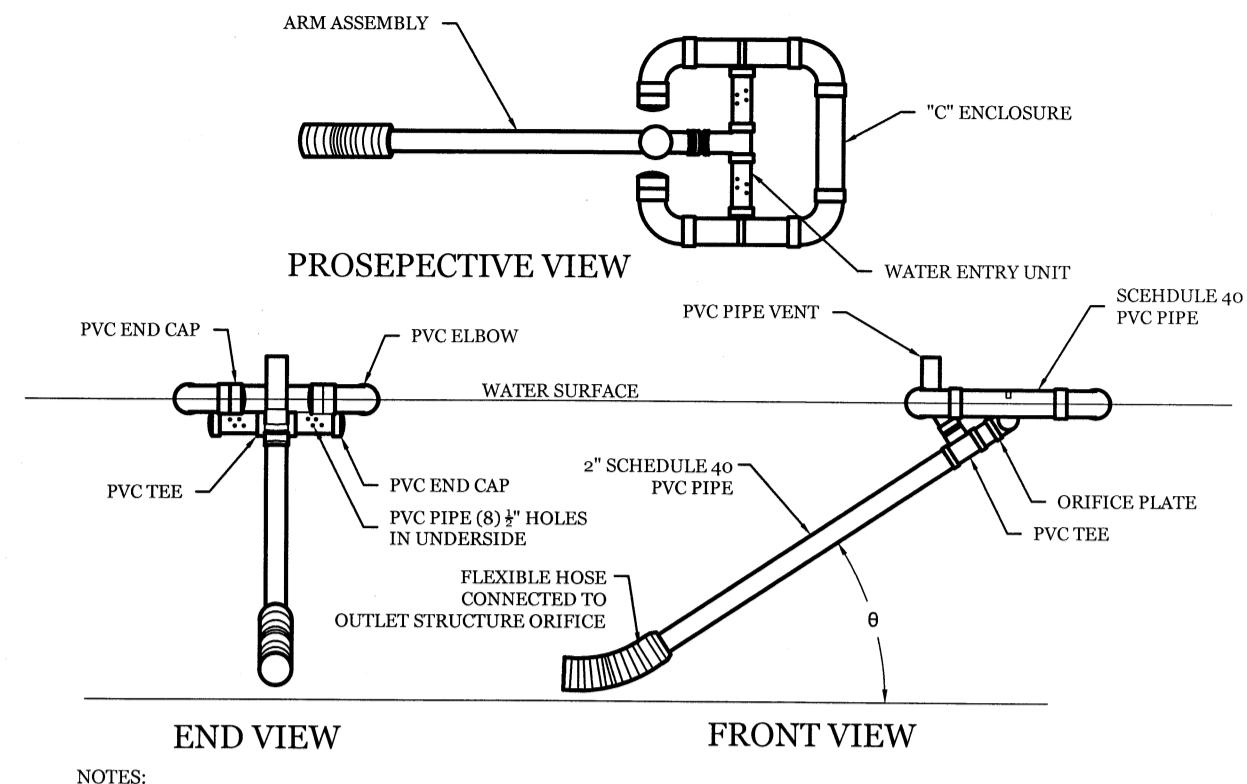

NOTES:
1. SKIMMER TO BE USED IN WET PONDS AND REMOVED AFTER SITE IS PERMANENTLY STABLE.

FAIRCLOTH SKIMMER DETAIL
NTS

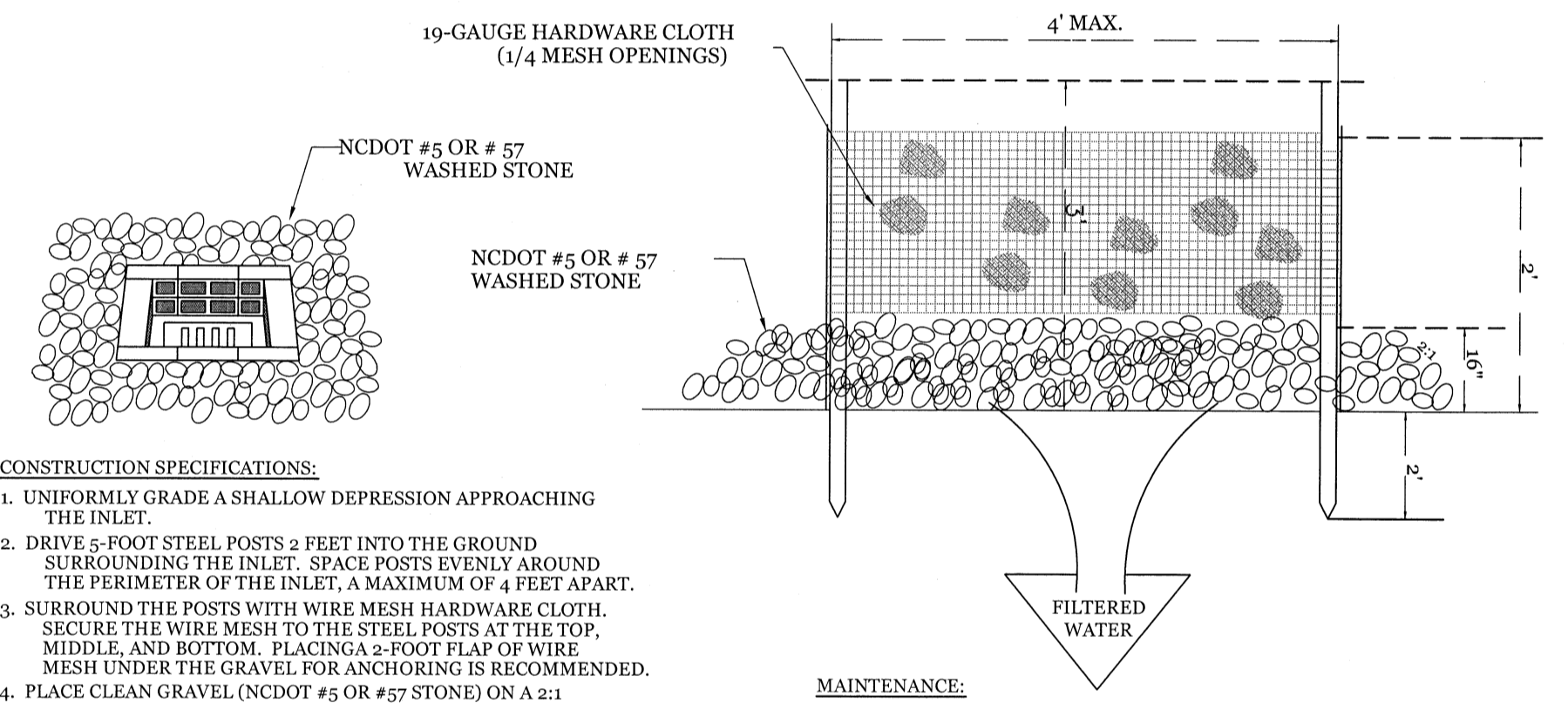

CONSTRUCTION SPECIFICATIONS:
1. UNIFORMLY GRADE A SHALLOW DEPRESSION APPROACHING THE INLET.
2. DRIVE 3-FOOT STEEL POSTS 2 FEET INTO THE GROUND SURROUNDING THE INLET. SPACE POSTS EVENLY AROUND THE PERIMETER OF THE INLET, A MAXIMUM OF 4 FEET APART.
3. SURROUND THE POSTS WITH WIRE MESH HARDWARE CLOTH. SECURE THE WIRE MESH TO THE STEEL POSTS AT THE TOP, MIDDLE, AND BOTTOM. PLACING A 2-FOOT FLAP OF WIRE MESH UNDER THE GRAVEL FOR ANCHORING IS RECOMMENDED.
4. PLACE CLEAN GRAVEL (NCDOT #5 OR #57 STONE) ON A 2:1 SLOPE WITH A HEIGHT OF 16 INCHES AROUND THE WIRE, AND SMOOTH TO AN EVEN GRADE.
5. ONCE THE CONTRIBUTING DRAINAGE AREA HAS BEEN STABILIZED, REMOVE ACCUMULATED SEDIMENT, AND ESTABLISH FINAL GRADING ELEVATIONS. TAKE CARE NOT TO DAMAGE OR UNDERCUT THE WIRE MESH DURING SEDIMENT REMOVAL. REPLACE STONE AS NEEDED.
6. COMPACT THE AREA PROPERLY AND STABILIZED IT WITH GROUND COVER.

MAINTENANCE:
INSPECT INLETS AT LEAST WEEKLY AND AFTER EACH SIGNIFICANT (4 INCH OR GREATER) RAINFALL EVENT. CLEAR THE MESH WIRE OF ANY DEBRIS OR OTHER OBJECTS TO PROVIDE ADEQUATE FLOW FOR SUBSEQUENT RAINS. TAKE CARE NOT TO DAMAGE OR UNDERCUT THE WIRE MESH DURING SEDIMENT REMOVAL. REPLACE STONE AS NEEDED.

HARDWARE CLOTH AND GRAVEL INLET PROTECTION
NTS

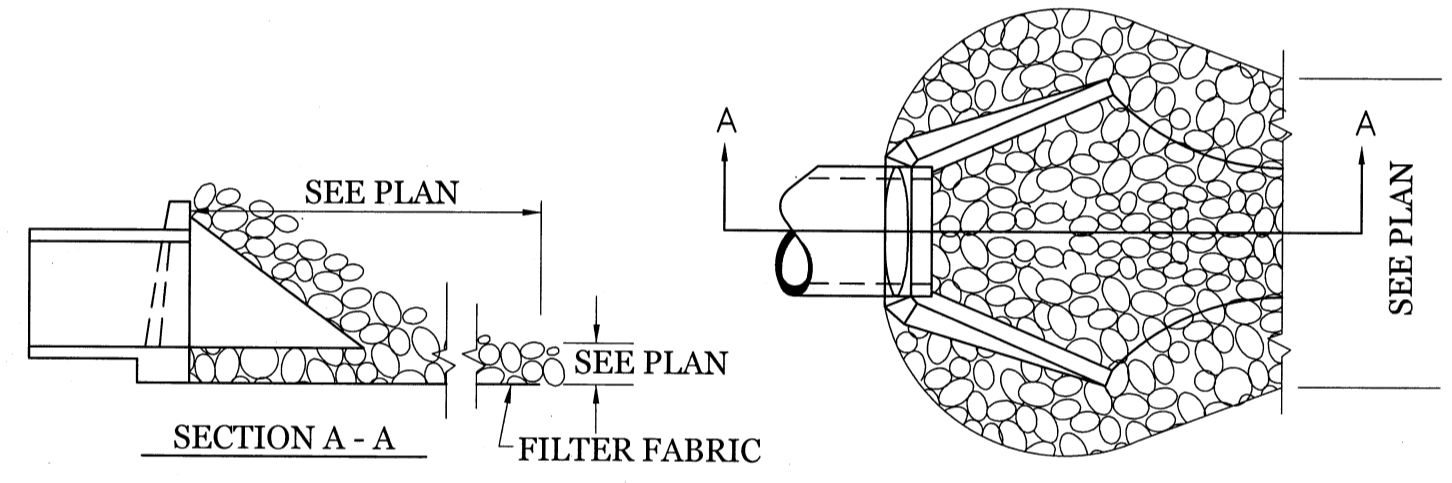

NOTES:
1. CLASS "B" RIP RAP TO BE USED FOR ALL ENERGY DISSIPATOR AREAS.

ENERGY DISSIPATOR
NTS

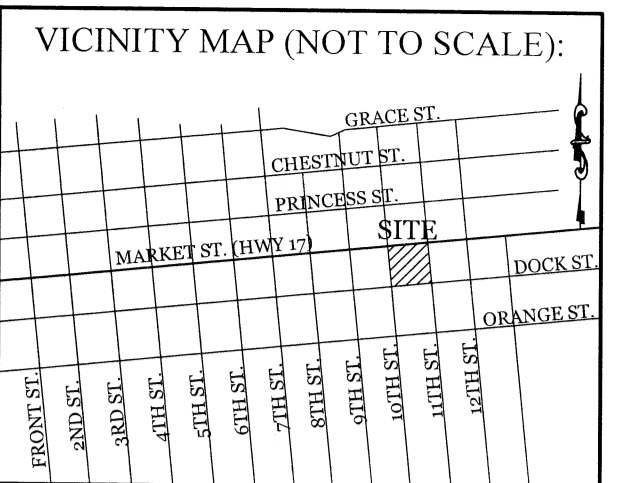

REVISIONS

INTRACOASTAL ENGINEERING, PLLC
5725 Oleander Dr. Unit E-7
Wilmington, North Carolina 28403
Phone: (910) 859-8983
Email: Charlie@intracoastalengineering.com
License Number P-0662

EROSION CONTROL DETAILS
FOR
FAMILY FARE MARKET ST.
WILMINGTON, NC

Charles D. Carter
10-21-16

STORMWATER MANAGEMENT PLAN
APPROVED
CITY OF WILMINGTON
ENGINEERING DEPARTMENT
DATE _____ PERMIT # _____
SIGNED _____

Approved Construction Plan

Name	Date
Planning _____	_____
Public Utilities _____	_____
Traffic _____	_____
Fire _____	_____

CLIENT INFORMATION:
M. M. FOWLER, INC.
LEE BARNES
4220 NEAL ROAD
DURHAM, NC 27705
919-309-2925 EXT. 215

DRAWN:	BPD	SHEET SIZE:	24 x 36
CHECKED:	CDC	DATE:	10/21/2016
APPROVED:	CDC	SCALE:	NTS
PROJECT NUMBER:	2015-049		

DRAWING NUMBER:
C-6
6 OF 8